

[Resolution of Formation - Special Tax District No. 2019-2 (Pier 70 Leased Properties)]

Resolution of formation of the City and County of San Francisco Special Tax District No. 2019-2 (Pier 70 Leased Properties) and a future annexation area; determining other matters in connection therewith, as defined herein; and making findings under the California Environmental Quality Act.

WHEREAS, California Statutes of 1968, Chapter 1333 ("Burton Act") and San Francisco Charter, Section 4.114 and Appendix B, beginning at Section B3.581, empower the City and County of San Francisco ("City"), acting through the San Francisco Port Commission ("Port" or "Port Commission"), with the power and duty to use, conduct, operate, maintain, manage, regulate, and control the lands within Port jurisdiction; and

WHEREAS, FC Pier 70, LLC, a Delaware limited liability company ("Master Developer") and the City, acting by and through the Port, are parties to a Disposition and Development Agreement (as amended from time to time, "DDA"), including a Financing Plan (as amended from time to time, "Financing Plan"), that governs the disposition and development of approximately 28 acres of land in the waterfront area of the City known as Pier 70 ("Project Site"); and

WHEREAS, In the general election held on November 4, 2014, an initiative entitled, the "Union Iron Works Historic District Housing, Waterfront Parks, Jobs and Preservation Initiative" ("Proposition F"), was approved by the voters in the City; and

WHEREAS, The DDA contemplates a project ("Project") under which the Port would initially lease the Project Site to the Master Developer for infrastructure development, and, ultimately, lease and sell parcels in the Project Site to vertical developers, for development of a mixed-use project described in the DDA; and

1 WHEREAS, The City anticipates that, in addition to the infrastructure and private
2 development described above, future improvements will be necessary to ensure that the
3 shoreline, public facilities, and public access improvements will be protected should sea level
4 rise in the vicinity of the Project Site, and the Board of Supervisors of the City ("Board")
5 desires to provide a mechanism to pay for the costs of such improvements; and

6 WHEREAS, At its hearing on August 24, 2017, and prior to recommending proposed
7 Planning Code amendments for approval, by Motion No. 19976, the Planning Commission
8 certified a Final Environmental Impact Report ("FEIR") for the Project (Case No. 2014-
9 001272ENV) pursuant to the California Environmental Quality Act ("CEQA") (California Public
10 Resources Code, Section 21000 et seq.), the CEQA Guidelines (14 Cal. Code Reg., Section
11 15000 et seq.), and Chapter 31 of the Administrative Code; a copy of said Motion is on file
12 with the Clerk of the Board in File No. 170930, and is incorporated herein by reference; and

13 WHEREAS, In recommending the proposed Planning Code amendments for approval
14 by this Board at its hearing on August 24, 2017, by Motion No. 19977, the Planning
15 Commission also adopted findings under CEQA, including a statement of overriding
16 consideration, and a Mitigation Monitoring and Reporting Program ("MMRP"); a copy of said
17 Motion and MMRP are on file with the Clerk of the Board in File No. 170930, and is
18 incorporated herein by reference; and

19 WHEREAS, Under Chapter 43, Article X of the San Francisco Administrative Code (as
20 it may be amended from time to time, "Code"), which Code incorporates by reference the
21 Mello-Roos Community Facilities Act of 1982, as amended ("Mello-Roos Act"), this Board is
22 authorized to establish a special tax district and to act as the legislative body for a special tax
23 district; and

24 ///

1 WHEREAS, On November 19, 2019, this Board adopted Resolution No. No. 502-19
2 entitled "Resolution declaring the intention of the Board to establish City and County of San
3 Francisco Special Tax District No. 2019-2 (Pier 70 Leased Properties) and a Future
4 Annexation Area; ordering and setting a time and place for a public hearing of the Board,
5 sitting as a Committee of the Whole, on January 14, 2020; determining other matters in
6 connection therewith, as defined herein; and making findings under the California
7 Environmental Quality Act" ("Resolution of Intention"), which Resolution of Intention was
8 signed by the Mayor on November 27, 2019, stating its intention to form (i) "City and County
9 of San Francisco Special Tax District No. 2019-2 (Pier 70 Leased Properties)" ("Special Tax
10 District") and (ii) a "City and County of San Francisco Special Tax District No. 2019-2 (Pier 70
11 Leased Properties) (Future Annexation Area)" ("Future Annexation Area"), pursuant to the
12 Code; and

13 WHEREAS, The Resolution of Intention incorporates a map of the proposed
14 boundaries of the Special Tax District and the Future Annexation Area; and

15 WHEREAS, The Resolution of Intention states the facilities, services and incidental
16 expenses to be financed by the Special Tax District (as set forth in the list attached hereto as
17 Exhibit A); and

18 WHEREAS, The City anticipates that future improvements will be necessary to ensure
19 that the shoreline, public facilities, and public access improvements will be protected should
20 sea level rise at the perimeter of the Project Site, and the Special Tax District would provide a
21 mechanism to finance such improvements; and

22 WHEREAS, The Resolution of Intention states the rate and method of apportionment of
23 the special taxes to be levied within the Special Tax District ("Rate and Method") to pay for the
24 costs of the authorized services, the authorized incidental expenses and the authorized
25 facilities, including the principal and interest on bonds and other debt (as defined in the Mello-

1 Roos Act) proposed to be issued with respect to the Special Tax District; and

2 WHEREAS, The Resolution of Intention is on file with the Clerk of the Board and the
3 provisions thereof are incorporated herein by this reference as if fully set forth herein; and

4 WHEREAS, As of the date hereof, there are no Leasehold Interests in Assessor's
5 Parcels (as defined in the Rate and Method) within the proposed boundaries of the Special
6 Tax District that are intended to be exempt from the levy of Special Taxes; the Board intends
7 for Leasehold Interests in Taxable Parcels within the proposed boundaries of the Special Tax
8 District that are purchased by a public entity (as defined in the Rate and Method), including
9 the United States, the State of California and/or the City, or any departments or political
10 subdivisions thereof ("public entity"), to be subject to the Special Tax, and if a public entity
11 purchases a Leasehold Interest in a Taxable Parcel in the Special Tax District after formation
12 of the Special Tax District, the obligation to pay Special Taxes on such Taxable Parcel shall
13 be governed by Section 53317.3 and 53317.5 of the Mello-Roos Act; and

14 WHEREAS, The levy of the Special Taxes in the Special Tax District shall be subject to
15 the approval of the qualified electors of the Special Tax District at a special election, and the
16 proposed voting procedure shall be by mailed or hand-delivered ballot among the landowners
17 in the Special Tax District, with each landowner having one vote for each acre or portion of an
18 acre such landowner owns in the Special Tax District not exempt from the Special Taxes; and

19 WHEREAS, The Director, Department of Elections has reported that there were no
20 registered voters in the boundaries of the proposed Special Tax District as of December 5,
21 2019; and

22 WHEREAS, This Board has received and accepted pursuant to the Resolution of
23 Intention a Public Agency Statement and Consent executed by the Port Commission in which
24 it declares that the City is a "landowner" (as defined in the Mello-Roos Act) in the Special Tax
25 District and qualified elector for the Special Tax District because the property owned by the

1 City within the proposed boundaries of the Special Tax District either will be (a) transferred by
2 conveyance of the fee interest to private ownership for the construction of improvements, in
3 which case the City agrees that such property will be subject to the special tax on the same
4 basis as private property within the Special Tax District and affirmatively waives any defense
5 based on the fact of public ownership to any action to foreclose on such property in the event
6 of nonpayment of the special tax or (b) leased to a nonexempt person or entity and, pursuant
7 to Section 53340.1 of the Mello-Roos Act, the special tax will be levied on the leasehold
8 interest and payable by the owner of the leasehold interest, a copy of which Public Agency
9 Statement and Consent is on file with the Clerk of the Board in File No. 191078 and is
10 incorporated herein by reference; and

11 WHEREAS, The Clerk of the Board published notice of a public hearing relative to the
12 proposed formation of the Special Tax District and the Future Annexation Area pursuant to
13 Section 53322 of the Mello-Roos Act and Section 53339.4 of the Mello-Roos Act, respectively;
14 and

15 WHEREAS, This Board has held a noticed public hearing as required by the Code and
16 the Resolution of Intention relative to the proposed formation of the Special Tax District and
17 the Future Annexation Area; and

18 WHEREAS, At the hearing all interested persons desiring to be heard on all matters
19 pertaining to the formation of the Special Tax District and the Future Annexation Area, the
20 facilities, services and incidental expenses to be provided therein and the levy of said special
21 taxes were heard and a full and fair hearing was held; and

22 WHEREAS, At the hearing evidence was presented to this Board on said matters
23 before it, including a report caused to be prepared by the Director of the Office of Public
24 Finance ("Report") as to the facilities, services and incidental expenses to be provided through
25 the Special Tax District and the costs thereof, a copy of which is on file with the Clerk of the

1 Board in File No. 191168, and this Board at the conclusion of said hearing is fully advised in
2 the matters related to the Special Tax District; and

3 WHEREAS, Written protests with respect to the formation of the Special Tax District,
4 the furnishing of specified types of facilities, services or incidental expenses or the rate and
5 method of apportionment of the special taxes have not been filed with the Clerk of the Board
6 by fifty percent (50%) or more of the registered voters residing within the territory of the
7 Special Tax District or six registered voters, whichever is more, or property owners of one-half
8 (1/2) or more of the area of land within the Special Tax District and not exempt from the
9 proposed special taxes; and

10 WHEREAS, Written protests have not been filed with the Clerk of the Board against the
11 proposed annexation of the Future Annexation Area to the Special Tax District by (i) 50% of
12 more of the registered voters, or six registered voters, whichever is more, residing in the
13 proposed boundaries of the Special Tax District, or (ii) 50% or more of the registered voters,
14 or six registered voters, whichever is more, residing in the Future Annexation Area, (iii)
15 owners of one-half or more of the area of land in the proposed Special Tax District and not
16 exempt from the proposed special tax or (iv) owners of one-half or more of the area of land in
17 the Future Annexation Area and not exempt from the proposed special tax; now, therefore, be
18 it

19 RESOLVED, That the foregoing recitals are true and correct; and, be it

20 FURTHER RESOLVED, That the proposed special taxes to be levied within the
21 Special Tax District and the designation of the Future Annexation Area has not been
22 precluded by majority protest pursuant to Mello-Roos Act Section 53324; and, be it

23 FURTHER RESOLVED, That all prior proceedings taken by this Board in connection
24 with the establishment of the Special Tax District and the Future Annexation Area and the levy
25 of the special tax have been duly considered and are hereby found and determined to be valid

1 and in conformity with the Code; and, be it

2 FURTHER RESOLVED, That the Special Tax District designated "City and County of
3 San Francisco Special Tax District No. 2019-2 (Pier 70 Leased Properties)" and the future
4 annexation area designated "City and County of San Francisco Special Tax District No. 2019-
5 2 (Pier 70 Leased Properties) (Future Annexation Area)" are hereby established pursuant to
6 the Code; and, be it

7 FURTHER RESOLVED, That the boundaries of the Special Tax District and the Future
8 Annexation Area as set forth in the map heretofore recorded in the Assessor-Recorder's
9 Office on December 12, 2019 at 5:00 p.m. as Document No. 2019-K876617-00 in Book 1
10 Page 171 of the Book of Maps of Assessment and Special Tax Districts are hereby approved,
11 are incorporated herein by reference and shall be the boundaries of the Special Tax District
12 and the Future Annexation Area, and the Board hereby ratifies the boundary map for the
13 Special Tax District and the Board hereby ratifies the boundary map for the Special Tax
14 District; and, be it

15 FURTHER RESOLVED, That, from time to time, parcels within the Future Annexation
16 Area shall be annexed to the Special Tax District only with the unanimous approval (each, a
17 "Unanimous Approval") of the owner or owners of each parcel or parcels at the time that such
18 parcel(s) are annexed; pursuant to Section 43.10.14 of the Code, a Unanimous Approval
19 executed by the owner of a parcel constitutes the vote of the qualified elector in favor of the
20 matters addressed in the Unanimous Approval for purposes of the California Constitution,
21 including, but not limited to, Articles XIII A and XIII C; and, be it

22 FURTHER RESOLVED, That the Board hereby determines that any property for which
23 the owner or owners execute a Unanimous Approval in accordance with applicable law shall
24 be added to the Special Tax District without any further hearings or proceedings and the Clerk
25 of the Board is hereby directed to record an amendment to the notice of special tax lien for the

1 Special Tax District pursuant to Streets & Highways Code, Section 3117.5 as a result of which
2 the obligation to pay the Special Tax shall become a lien upon the annexed property;
3 provided, however, the designation of property as Future Annexation Area and the ability to
4 annex property to the Special Tax District based on a Unanimous Approval shall not limit, in
5 any way, the annexation of property in the Future Annexation Area to the Special Tax District
6 pursuant to other provisions of applicable law; and, be it

7 FURTHER RESOLVED, That the Director of the Controller's Office of Public Finance
8 ("Director") is hereby directed, from time to time in her discretion, to cause to be recorded one
9 or more consolidated maps of the Special Tax District reflecting all prior modifications,
10 amendments, and annexations pursuant to Section 3113.5 of the Streets & Highways Code;
11 and, be it

12 FURTHER RESOLVED, That in order to advance the public purposes of the City, the
13 type of facilities proposed to be financed by the Special Tax District (as originally designated
14 and as may be expanded by annexation) and pursuant to the Code shall consist of those
15 items listed as facilities in Exhibit A hereto and by this reference incorporated herein
16 ("Facilities"); and, be it

17 FURTHER RESOLVED, That in order to advance the public purposes of the City, the
18 type of public services proposed to be financed by the Special Tax District (as originally
19 designated and as may be expanded by annexation) pursuant to the Code shall consist of
20 those items shown in Exhibit A hereto and by this reference incorporated herein ("Services");
21 and, be it

22 FURTHER RESOLVED, That in order to advance the public purposes of the City, the
23 Special Taxes and proceeds of bonds and other debt issued by the Special Tax District may
24 be used to finance the incidental expenses shown in Exhibit A hereto and by this reference
25 incorporated herein ("incidental expenses"); and, be it

1 FURTHER RESOLVED, That except to the extent that funds are otherwise available to
2 the Special Tax District to pay for the Services, incidental expenses and Facilities and/or the
3 principal and interest as it becomes due on bonds or other debt of the Special Tax District
4 issued to finance the Facilities or incidental expenses, certain special taxes ("Special Tax")
5 sufficient to pay the costs thereof, secured by the recordation of a continuing lien against all
6 non-exempt real property in the Special Tax District, is intended to be levied annually within
7 the Special Tax District, and collected in the same manner as ordinary *ad valorem* property
8 taxes or in such other manner as may be prescribed by this Board; and, be it

9 FURTHER RESOLVED, That the Board expects the non-exempt real property to
10 consist of leasehold or possessory interests in land owned by the City or the Port
11 Commission, and hereby approves the levy of Special Taxes on such leasehold or
12 possessory interests on the secured roll; and, be it

13 FURTHER RESOLVED, That the proposed rate and method of apportionment of the
14 Special Taxes among the parcels of real property within the Special Tax District, in sufficient
15 detail to allow each landowner or lessee within the proposed Special Tax District to estimate
16 the maximum amount such owner or lessee will have to pay, are set forth in the Rate and
17 Method, which is included in Exhibit B attached hereto and hereby incorporated herein; and,
18 be it

19 FURTHER RESOLVED, That the territory in the Future Annexation Area will be
20 annexed into the Special Tax District and the Special Taxes will be levied on such territory
21 only with the Unanimous Approval of the owner or owners of each parcel or parcels at the
22 time that parcel or those parcels are annexed into the Special Tax District. Except to the
23 extent that funds are otherwise available to the Special Tax District to pay for the Services,
24 incidental expenses or Facilities and/or the principal and interest as it becomes due on bonds
25 or other debt of the Special Tax District issued to finance the Facilities or incidental expenses,

1 the Special Taxes sufficient to pay the costs thereof, secured by the recordation of a
2 continuing lien against all non-exempt real property in the portion of the Future Annexation
3 Area that is annexed to the Special Tax District, is intended to be levied annually within the
4 portion of the Future Annexation Area that is annexed to the Special Tax District, and
5 collected in the same manner as ordinary *ad valorem* property taxes or in such other manner
6 as may be prescribed by this Board; and, be it

7 FURTHER RESOLVED, That as required by Mello-Roos Act, Section 53339.3(d), the
8 Special Tax proposed to pay for the Facilities to be supplied within the portion of the Future
9 Annexation Area that is annexed to the Special Tax District that are financed with bonds that
10 have already been issued and that are secured by previously-existing areas of the Special
11 Tax District will be equal to the Special Taxes levied to pay for the same Facilities in
12 previously-existing areas of the Special Tax District, except that (i) a higher Special Tax may
13 be levied within the portion of the Future Annexation Area that is annexed to the Special Tax
14 District to pay for the same Facilities to compensate for the interest and principal previously
15 paid from Special Taxes in the original area of the Special Tax District, less any depreciation
16 allocable to the financed Facilities and (ii) a higher Special Tax may be levied in the portion of
17 the Future Annexation Area that is annexed to the Special Tax District to pay for new or
18 additional Facilities, with or without bond financing; and, be it

19 FURTHER RESOLVED, That as required by the Mello-Roos Act, this Board further
20 determined in the Resolution of Intention that the Special Tax proposed to pay for Services to
21 be supplied within the portion of the Future Annexation Area that is annexed to the Special
22 Tax District shall be equal to any Special Tax levied to pay for the same Services in the
23 existing Special Tax District, except that a higher or lower tax may be levied within the portion
24 of the Future Annexation Area that is annexed to the Special Tax District to the extent that the
25 actual cost of providing the Services in the portion of the Future Annexation Area that is

1 annexed to the Special Tax District is higher or lower than the cost of providing those Services
2 in the existing Special Tax District. In so finding, this Board does not intend to limit its ability
3 to levy a Special Tax within the portion of the Future Annexation Area that is annexed to the
4 Special Tax District to provide new or additional services beyond those supplied within the
5 existing Special Tax District or its ability to implement changes to the extent permitted by law;
6 and, be it

7 FURTHER RESOLVED, That the Special Taxes to be levied in the Special Tax District
8 shall not be levied in the Special Tax District to finance Facilities after the fiscal year
9 established for that purpose in the Rate and Method, except that a Special Tax that was
10 lawfully levied in or before the final tax year and that remains delinquent may be collected in
11 subsequent years; under no circumstances shall the Special Taxes levied against any parcel
12 in the Special Tax District to finance Facilities ("Facilities Special Tax") in any fiscal year be
13 increased in that fiscal year as a consequence of delinquency or default by the owner or
14 lessee of any other parcel or parcels within the Special Tax District by an amount that
15 exceeds 10 percent of the maximum Facilities Special Tax applicable to such parcel for that
16 fiscal year. For avoidance of doubt, the term Facilities Special Tax as used in this paragraph
17 includes the "Facilities Special Tax," the "Arts Building Special Tax," and the "Shoreline
18 Special Tax" as such terms are defined in the Rate and Method, and applies equally to
19 residential and non-residential property; and, be it

20 FURTHER RESOLVED, That it is hereby found and determined that the Facilities,
21 Services and incidental expenses are necessary to meet increased demands placed upon
22 local agencies as the result of development occurring in the Special Tax District; and, be it

23 FURTHER RESOLVED, That the Director of the Office of Public Finance, 1 Dr. Carlton
24 B. Goodlett Place, San Francisco, CA 94102, 415-554-5956, is the officer of the City who will
25 be responsible for preparing annually a current roll of special tax levy obligations by

1 assessor's parcel number and who will be responsible for estimating future special tax levies
2 pursuant to the Code; and, be it

3 FURTHER RESOLVED, That upon recordation of a notice of special tax lien pursuant
4 to Section 3114.5 of the Streets and Highways Code of California, a continuing lien to secure
5 each levy of the special tax shall attach to all nonexempt real property in the Special Tax
6 District and this lien shall continue in force and effect until the special tax obligation is prepaid
7 and permanently satisfied and the lien canceled in accordance with law or until collection of
8 the tax by the City ceases; and, be it

9 FURTHER RESOLVED, That in accordance with the Mello-Roos Act, the annual
10 appropriations limit, as defined by subdivision (h) of Section 8 of Article XIII B of the California
11 Constitution, of the Special Tax District is hereby preliminarily established at \$1,841,600,000,
12 and said appropriations limit shall be submitted to the voters of the Special Tax District as
13 hereafter provided; the proposition establishing said annual appropriations limit shall become
14 effective if approved by the qualified electors voting thereon and shall be adjusted in
15 accordance with the applicable provisions of the Code; and, be it

16 FURTHER RESOLVED, That pursuant to the provisions of the Code, the proposition of
17 the levy of the special tax and the proposition of the establishment of the appropriations limit
18 specified above shall be submitted to the qualified electors of the Special Tax District at an
19 election; the time, place and conditions of the election shall be as specified by a separate
20 resolution of this Board; and, be it

21 FURTHER RESOLVED, That Mello-Roos, Act Section 53314.9 provides that, either
22 before or after formation of the Special Tax District, the City may accept advances of funds
23 and may provide, by resolution, for the use of those funds, including but not limited to pay any
24 cost incurred by the local agency in creating the Special Tax District, and may agree to
25 reimburse the advances under all of the following conditions: (A) the proposal to repay the

1 advances is included both in the resolution of intention and the resolution of formation to
2 establish the Special Tax District; and (B) any proposed special tax is approved by the
3 qualified electors of the Special Tax District and, if the qualified electors of the Special Tax
4 District do not approve the proposed special tax, the City shall return any funds which have
5 not been committed for any authorized purpose by the time of the election and, in furtherance
6 of Mello-Roos Act, Section 53314.9, the Board hereby declares its intent to enter into an
7 agreement providing for the advance and reimbursement of funds between the Port and the
8 Master Developer; and, be it

9 FURTHER RESOLVED, That Mello-Roos Act, Section 53314.9 provides that, either
10 before or after formation of the Special Tax District, the City may accept work in-kind from any
11 source, including, but not limited to, private persons or private entities, may provide, by
12 resolution, for the use of that work in-kind for any authorized purpose and this Board may
13 enter into an agreement, by resolution, with the person or entity advancing the work in-kind, to
14 reimburse the person or entity for the value, or cost, whichever is less, of the work in-kind, as
15 determined by this Board, with or without interest, under the conditions specified in the Mello-
16 Roos Act; any work in-kind must be performed or constructed as if the work had been
17 performed or constructed under the direction and supervision, or under the authority of, the
18 City and, in furtherance of Mello-Roos Act, Section 53314.9, the Board previously authorized
19 the Port to enter into an acquisition and reimbursement agreement with the Master Developer
20 and other entities responsible for developing the Project pursuant to Resolution No. 401-17,
21 adopted by this Board on October 31, 2017 (which resolution was signed by the Mayor on
22 November 9, 2017); and, be it

23 FURTHER RESOLVED, That this Board reserves to itself the right and authority set
24 forth in Mello-Roos Act, Section 53344.1, subject to any limitations set forth in any bond
25 resolution or trust indenture related to the issuance of bonds; and, be it

1 FURTHER RESOLVED, That this Board hereby waives any provisions of the Amended
2 and Restated Local Goals and Policies for Community Facilities Districts and Special Tax
3 Districts ("Goals and Policies") adopted by this Board by Resolution No. 414-13 to the extent
4 the Goals and Policies are inconsistent with the provisions hereof or the DDA; and, be it

5 FURTHER RESOLVED, That the Board hereby approves and ratifies the appointment
6 of the Port as the CFD Agent (as defined in the DDA) for the Special Tax District and
7 approves and ratifies all actions taken prior to the date hereof by the Port in its capacity as
8 CFD Agent, including, but not limited to, ratification or execution of one or more promissory
9 notes to evidence the repayment of one or more advances of land proceeds and other
10 sources of Port funding to pay the costs of the Facilities and incidental expenses (the
11 "Repayment Obligation") and execution of one more pledge agreements with an infrastructure
12 financing district to receive property tax revenues to repay the Repayment Obligation; and, be
13 it

14 FURTHER RESOLVED, That in accordance with the actions contemplated herein, this
15 Board has reviewed the FEIR, concurs with its conclusions, affirms the Planning
16 Commission's certification of the FEIR, and finds that the actions contemplated herein are
17 within the scope of the Project described and analyzed in the FEIR; and, be it

18 FURTHER RESOLVED, That this Board hereby adopts and incorporates by reference
19 as though fully set forth herein the Planning Commission's CEQA approval findings in the
20 MMRP, including the statement of overriding considerations, and adopts and incorporates by
21 reference as though fully set forth herein the Project's MMRP; and, be it

22 FURTHER RESOLVED, That if any section, subsection, sentence, clause, phrase, or
23 word of this Resolution, or any application thereof to any person or circumstance, is held to be
24 invalid or unconstitutional by a decision of a court of competent jurisdiction, such decision
25 shall not affect the validity of the remaining portions or applications of this Resolution, this

1 Board hereby declaring that it would have passed this Resolution and each and every section,
2 subsection, sentence, clause, phrase, and word not declared invalid or unconstitutional
3 without regard to whether any other portion of this Resolution or application thereof would be
4 subsequently declared invalid or unconstitutional; and, be it

5 FURTHER RESOLVED, That the Mayor, the Controller, the Director, Department of
6 Elections, Director of the Office of Public Finance, the Clerk of the Board and any and all other
7 officers of the City are hereby authorized, for and in the name of and on behalf of the City, to
8 do any and all things and take any and all actions, including execution and delivery of any and
9 all documents, assignments, certificates, requisitions, agreements, notices, consents,
10 instruments of conveyance, warrants and documents, which they, or any of them, may deem
11 necessary or advisable in order to effectuate the purposes of this Resolution; provided
12 however that any such actions be solely intended to further the purposes of this Resolution,
13 and are subject in all respects to the terms of the Resolution; and, be it

14 FURTHER RESOLVED, That all actions authorized and directed by this Resolution,
15 consistent with any documents presented herein, and heretofore taken are hereby ratified,
16 approved and confirmed by this Board; and, be it

17 FURTHER RESOLVED, That this Resolution shall take effect upon its adoption.
18

19 APPROVED AS TO FORM:
20 DENNIS J. HERRERA, City Attorney

21
22 By: _____

23 MARK D. BLAKE
24 Deputy City Attorney

25 n:\legana\as2019\2000155\01412067.docx

1 **EXHIBIT A**

2 CITY AND COUNTY OF SAN FRANCISCO

3 Special Tax District No. 2019-2
4 (Pier 70 Leased Properties)

5 DESCRIPTION OF FACILITIES, SERVICES AND OTHER COSTS TO BE
6 FINANCED BY THE SPECIAL TAX DISTRICT
7

8 City and County of San Francisco Special Tax District No. 2019-2 (Pier 70 Leased Properties)
9 (as originally configured and as expanded through annexation of property in the future, the
10 "STD"), is authorized to finance the Facilities, Services and Incidental Costs described in this
11 Exhibit A. Capitalized terms used in this Exhibit A but not defined herein have the meaning
12 given them in the Appendix to Transaction Documents for the Pier 70 28-Acre Site Project,
13 attached as an appendix to the Disposition and Development Agreement ("DDA"), dated as of
14 May 2, 2018, by and between the Port and the Developer, including all exhibits and
15 attachments, as may be amended from time to time. When used in this Exhibit A, "including"
16 has the meaning given to it in the DDA.
17

18 **AUTHORIZED FACILITIES**
19

20 The STD is authorized to finance the purchase, construction, reconstruction, expansion,
21 improvement, or rehabilitation of all or any portion of the facilities authorized to be financed by
22 the San Francisco Special Tax Financing Law (Admin. Code ch. 43, art. X) and the Mello-
23 Roos Community Facilities Act of 1982 (Cal. Gov't Code Section 53311 et seq.), including:

- 24 1. Land Acquisition – includes, but is not limited to, acquisition of land for public
25 improvements or for other requirements under the DDA.

2. Demolition and Abatement – includes, but is not limited to, Site Preparation costs, including abatement of hazardous materials, removal of below-grade, at-grade, and above-grade facilities, and recycling or disposal of waste, including demolition and abatement within future vertical sites that is necessary for Horizontal Improvements.
3. Auxiliary Water Supply System - includes, but is not limited to, main pipe, laterals, valves, fire hydrants, cathodic protection, tie-ins, and any other components required for onsite and offsite high pressure water supply network intended for fire suppression.
4. Low Pressure Water - includes, but is not limited to, main pipe, laterals, water meters, water meter boxes, back flow preventers, gate valves, air valves, blow-offs, fire hydrants, cathodic protection, tie-ins, and any other components required for onsite and offsite low pressure water supply network intended for domestic use.
5. Non-Potable Water - includes, but is not limited to, main pipe, laterals, water meters, water meter boxes, back flow preventers, gate valves, air valves, blow-offs, cathodic protection, tie-ins, blackwater treatment facility (whether publicly or privately owned), and any other components required for non-potable water supply network intended to provide treated wastewater for use in, among other things, irrigation of parks, landscaping, and non-potable uses within buildings.
6. Combined Sanitary Sewer and Stormwater Management– includes, but is not limited to, retrofit of existing combined sewer facilities, new gravity main pipe, force main pipe and associated valves, laterals, manholes, catch basins, traps, air vents, pump stations, outfalls, lift stations, connections to existing systems, stormwater treatment

1 BMPs such as detention vaults, and any other components required for a network
2 intended to convey storm water and sanitary sewage, including components, such as
3 ejector pumps, associated with vertical buildings to meet design criteria for the
4 Horizontal Improvements.

5
6 7. Joint Trench & Dry Utilities – includes, but is not limited to, installation of primary and
7 secondary conduits, overhead poles, pull boxes, vaults, subsurface enclosures, gas
8 main, and anodes for dry utilities including electrical, gas, telephone, cable, internet,
9 and information systems.

10
11 8. Earthwork and Retaining Walls – includes, but is not limited to, Site Preparation
12 activities including importation of clean fill materials, clearing and grubbing, slope
13 stabilization, ground improvement, installation of geogrid, surcharging, wick drains,
14 excavation, rock fragmentation, grading, placement of fill, compaction, retaining walls,
15 subdrainage, erosion control, temporary fencing, and post-construction stabilization
16 such as hydroseeding. Also, includes, but is not limited to, excavation of future vertical
17 development sites if the excavated soils is used on site for purposes of raising
18 Horizontal Improvements.

19
20 9. Roadways – includes, but is not limited to, Public ROWs, road subgrade preparation,
21 aggregate base, concrete roadway base, asphalt wearing surface, concrete curb,
22 concrete gutter, medians, colored asphalt and concrete, pavers, speed bumps,
23 sawcutting, grinding, conform paving, resurfacing, any other components required for
24 onsite and offsite roadways, transit stops, bus facilities, permanent pavement marking
25 and striping, traffic control signage, traffic light signals, offsite traffic improvements, and

any other components or appurtenant features as required in the approved Improvement Plan details and specifications. through the permitting process.

10. Streetscape – includes, but is not limited to, subgrade preparation, aggregate base, sidewalks, pavers, ADA curb ramps with detectable tiles, streetlights, light pole foundations, signage, emergency services infrastructure, landscaping (including trees and silva cells and/or structural soil), irrigation, street furniture, waste receptacles, bike racks, shared bike parking facilities (whether publicly or privately owned), newspaper stands, any other components or appurtenant features as required in the approved Improvement Plan details and specifications through the permitting process, and interpretative signage and facilities.

11. Parks and Public Space – includes, but is not limited to, fine grading, storm drainage and treatment, sanitary sewer, low pressure water, park lighting, community wifi, security infrastructure, low-voltage electrical, various hardscaping, irrigation, landscaping, various concrete structures, site furnishings, public art, viewing platforms, retrofit of shoreline structures and slopes (including demolition, excavation, installation of revetment, structural repair, and any other components, e.g., Shoreline Improvements), and any other associated work in publicly accessible spaces such as parks, open spaces, plazas, and mid-block passages, including publicly-accessible parks, plazas, mid-block passages and open space that is located on private property, but identified as public open space, mid-block passages, streets or streetscapes in the DDA or Design for Development.

- 1 12. Historic Rehabilitation Required for Horizontal Improvements – includes, but is not
2 limited to, eligible cost for relocation, structural retrofit, repair, and rehabilitation of
3 historic buildings associated with horizontal public improvements, such as Building 12
4 lifting, Building 21 relocation, Building 108 reuse for blackwater treatment, and Building
5 15 structural frame.
- 6
- 7 13. Hazardous Soil Removal – includes, but is not limited to, removal and disposal of
8 contaminated soil which cannot be reused on site in accordance with the Pier 70 Risk
9 Management Plan, Pier 70 Master Plan Area, dated July 25, 2013, and associated with
10 Horizontal Improvements.
- 11
- 12 14. Shoreline Adaptation Studies – includes, but is not limited to, analysis and planning to
13 characterize the preferred Shoreline Protection Project and alternatives, including pre-
14 entitlement planning and design work, environmental review, negotiation, and
15 Regulatory Approvals related to the Shoreline Protection Facilities, conducted in
16 accordance with Pier 70 Financing Plan Section 4.7(f) (Determining Pier 70 Shoreline
17 Protection Facilities).
- 18
- 19 15. Shoreline Protection Facilities includes, but is not limited to, future waterfront
20 Improvements at the San Francisco shoreline to protect the area from perils associated
21 with seismic events and climate change, including sea level rise and floods, and other
22 public improvements approved by the Port Commission and the Board of Supervisors.
- 23
- 24 16. Noonan Replacement Space, a space to accommodate the Noonan Space Lease in a
25 new or rehabilitated building that meets the requirements of DDA § 7.13 (Noonan

1 Replacement Space) for which the Port has issued a Temporary Certificate of
2 Occupancy and Noonan moving costs related to relocating Noonan Tenants from the
3 existing Noonan Building to the Noonan Replacement Space.

4
5 17. Arts Building, a new building on Parcel E4 with space dedicated and restricted to
6 arts/light industrial uses in accordance with DDA § 7.12 (Arts Building) and the Arts
7 Program, as well as community space that can be funded under the Financing Plan.

8
9 18. Historic Building Feasibility Gap as specified in Financing Plan Section 11.1 (Subsidy
10 for Historic Buildings 12 and 21).

11
12 19. Deferred Infrastructure.

13
14 20. Entitlement costs, including Entitlement Costs and costs to obtain approvals necessary
15 to proceed with development, incurred after the Reference Date to develop
16 improvements authorized to be financed by the San Francisco Special Tax Financing
17 Law (Admin. Code ch. 43, art. X) and the Mello-Roos Community Facilities Act of 1982
18 (Cal. Gov't Code Section 53311 et seq.), such as the cost to comply with the California
19 Environmental Quality Act, negotiate transaction documents, permitting of Horizontal
20 Improvements, subdivision mapping, conduct community outreach, and prepare
21 development design and land use requirements, but not expenses related to any
22 campaign or ballot measure or any other expenses prohibited by law. Entitlement costs
23 may include interim costs as approved from time to time by the Board of Supervisors.

24
25 21. Associated Public Benefits.

- 1 22. Miscellaneous Horizontal Development Costs - any other Horizontal Development
2 Costs associated with implementing the DDA, including any additional costs that the
3 Parties agree shall be incurred by the Developer for the Project, including workforce
4 liaisons; studies and consultants required to comply with the DDA, such as auditors,
5 inspectors, attorneys and appraisers; replacement and rework costs, including repairs
6 to correct incidental damage that occurs throughout the course of construction and
7 restoration of roadway pavement in areas where there are trenches excavated after the
8 initial roadway is paved, and maintenance prior to acceptance by the City and/or Port.
9
- 10 23. Any other costs authorized to be financed by the STD under the DDA.
11
- 12 24. Soft Costs required to support the construction of the Horizontal Improvements and
13 implementation of the DDA, including developer management costs, construction
14 management Fees, and asset management costs.
15
- 16 25. Developer Mitigation Measures, including the formation of the Transportation
17 Management Association and dust, vibration and asbestos monitoring.
18
- 19 26. Miscellaneous Costs, such as costs associated with implementing the DDA, including
20 any additional costs that the Parties have agreed shall be incurred by the Developer for
21 the Project, such as master planning for each phase, audits, appraisals, workforce
22 development costs (such as a liaison), cash payments and community outreach
23 initiatives.
24
25

1 Any facility authorized to be financed by the STD may be financed through the construction
2 and acquisition of the facility or through the payment of fees for such facility.

3
4 The facilities authorized to be financed may be located within or outside the boundaries of the
5 STD.

6
7 The facilities to be financed shall include all Hard Costs and Soft Costs associated with the
8 facilities, including the costs of the acquisition of land and rights-of-way, the costs of design,
9 engineering and planning, the costs of any environmental or traffic studies, surveys or other
10 reports, costs related to landscaping and irrigation, soils and other environmental testing and
11 observation, permits, plan check, and inspection fees, insurance, legal and related overhead
12 costs, bonding, trailer rental, utility bills, site security, coordination and supervision and any
13 other costs or appurtenances related to any of the foregoing as further defined in one or more
14 acquisition agreements with the developer of the property in the STD.

15
16 The facilities to be financed shall also include all incidental expenses, defined as follows:

- 17
- 18 1. The cost of planning and designing facilities to be financed by the STD, including the
19 cost of environmental evaluations of those facilities.
 - 20 2. The costs associated with the creation of the STD, issuance of bonds, determination of
21 the amount of taxes, collection of taxes, payment of taxes, or costs otherwise incurred
22 in order to carry out the authorized purposes of the STD.
- 23
24
25

3. Any other expenses incidental to the construction, completion, and inspection of the authorized work, including costs for temporary facilities with a useful life of at least 3 years that are required to construct an authorized facility.
4. Special taxes levied on a property in the STD and paid by the Master Developer on behalf of a local agency or other landowner prior to the development of the property.

The facilities to be financed also includes the interim cost of the facilities, which shall mean the Developer Return or Port Return, as applicable, and any interest payable on any promissory note payable to the STD.

The STD may also apply bond proceeds and special taxes to repay the Port Commission for advances made to pay for authorized costs, under any promissory note or otherwise.

Special taxes may be collected and set-aside in designated funds and collected over several years (i.e., reserves), and used to fund facilities authorized to be financed by the STD.

AUTHORIZED SERVICES

Special taxes collected in the STD may finance, in whole or in part, the services authorized to be financed by the San Francisco Special Tax Financing Law (Admin. Code ch. 43, art. X) and the Mello-Roos Community Facilities Act of 1982 (Cal. Gov't Code Section 53311 et seq.), in and to the extent permitted by the DDA outside the FC Project Area, including:

- 1 • Maintenance, capital repair, replacement and operation (including public events) of
2 Public Spaces, including facilities for public enjoyment, such as public parks, public
3 recreational facilities, public access, open space, and other public amenities, some of
4 which may be rooftop facilities or located on privately leased property but identified as
5 public open space in the DDA or Design for Development.
6
- 7 • Maintenance, capital repair, replacement and operation of Public Right-of-Ways
8 (ROWs), including public streets, sidewalks, shared public ways, mid-block passages,
9 bicycle lanes, and other paths of travel, associated landscaping and furnishings,
10 retaining walls within the ROWs, and related amenities in the FC Project Area,
11 including any portion of the Building 15 structure over 22nd Street, some of which may
12 be located on privately leased property but identified as public open space in the DDA
13 or Design for Development.
14
- 15 • Maintenance, capital repair, replacement and operation of Shoreline Improvements in
16 and adjacent to the FC Project Area that were completed per the DDA, such as
17 shoreline restoration, including installation of stone columns, pilings, secant walls, and
18 other structures to stabilize the seawall or shoreline, removal of bay fill, creation of
19 waterfront public access to or environmental remediation of the San Francisco
20 waterfront.
21
- 22 • Maintenance, capital repair, replacement and operation of landscaping and irrigation
23 systems and other equipment, material, and supplies directly related to maintaining and
24 replacing landscaped areas and water features in Public Spaces and Public ROWs.
25

- 1 • Maintenance, capital repair, replacement and operation as needed of Public Spaces,
2 including street cleaning and paving.
- 3
- 4 • Maintenance, capital repair, replacement and operation of lighting, rest rooms, trash
5 receptacles, park benches, planting containers, picnic tables, bollards, bicycle racks
6 and corrals, and other furniture and fixtures and signage in Public Spaces and Public
7 ROWs.
- 8
- 9 • Maintenance, capital repair, replacement and operation of utilities in Public Spaces and
10 Public ROWs.
- 11
- 12 • General liability insurance for any Public ROWs or structures in Public ROWs that
13 Public Works does not submit to the Board of Supervisors for City acceptance for City
14 General Fund liability purposes and other commercially reasonable insurance
15 coverages.
- 16
- 17 • Port, City, or third party personnel, administrative, and overhead costs related to
18 maintenance or to contracting for and managing third-party maintenance, including rent
19 for storage space needed to support the maintenance activities.
- 20
- 21 • Any other costs authorized to be financed by the STD under the DDA.
- 22

23 Special taxes may be collected and set-aside in designated funds and collected over
24 several years (i.e., reserves), and used to fund services authorized to be financed by
25 the STD. The term “operation” includes providing security and hosting special events.

INCIDENTAL COSTS

Special taxes collected in the STD will also fund, in whole or in part, the incidental costs associated with the facilities and services authorized to be financed. Incidental costs include, but are not limited to:

1. Administrative expenses and fees including costs incurred to form the STD, to annex territory to the STD, to annually administer the STD, to levy and collect special taxes for the STD, and any other costs incurred in standard administration of the STD by the City or their authorized consultants;
2. Any amounts needed to cure actual or estimated delinquencies in special taxes for the current or previous fiscal years;
3. Bond related expenses, including underwriters discount, reserve fund, capitalized interest, bond, disclosure, and underwriter counsel fees and all other incidental expenses; and
4. Reimbursement of costs related to the formation of the STD advanced by the City and any landowner(s) in the STD, or any party related to any of the foregoing, as well as reimbursement of any costs advanced by the City or any landowner(s) in the STD or any party related to any of the foregoing, for facilities, fees or other purposes or costs of the STD.

EXHIBIT B

**CITY AND COUNTY OF SAN FRANCISCO
Community Facilities District No. 2019-2
(Pier 70 Leased Properties)**

RATE AND METHOD OF APPORTIONMENT OF SPECIAL TAX

Special Taxes applicable to the Leasehold Interest in each Taxable Parcel in the City and County of San Francisco Special Tax District No. 2019-2 (Pier 70 Leased Properties) shall be levied and collected according to the tax liability determined by the Administrator through the application of the appropriate amount or rate for Leasehold Interests in Taxable Parcels, as described below. The Leasehold Interest in all Taxable Parcels in the STD shall be taxed for the purposes, to the extent, and in the manner herein provided, including property subsequently annexed to the STD.

Special Taxes shall be levied only on Leasehold Interests in Taxable Parcels. In the event a Leasehold Interest in a Taxable Parcel is terminated, the Special Taxes shall be levied on any successor Leasehold Interest in the Taxable Parcel. If a Leasehold Interest terminates while a Special Tax that was previously levied remains unpaid, the owner of the successor Leasehold Interest will take the interest subject to the obligation to pay the unpaid Special Tax along with any applicable penalties and interest.

The City will covenant in each Indenture that, as long as any Bonds are outstanding, it will not terminate, and it will inhibit the Port from terminating, any Leasehold Interest in a Taxable Parcel unless the Port enters into a new lease the term of which ends on or after the final maturity date of the Bonds and that covers substantially the same real property and improvements as the terminated lease. It will not be a violation of this covenant if the City or the Port initiates judicial foreclosure of any such lease pursuant to the CFD Law.

1 **A. DEFINITIONS**

2 The terms hereinafter set forth have the following meanings:

3 **“28-Acre Site”** is defined in the Appendix.

4

5 **“Administrative Expenses”** means any or all of the following: the fees and expenses of any
6 fiscal agent or trustee (including any fees or expenses of its counsel) employed in connection
7 with any Bonds, and the expenses of the City carrying out duties with respect to the STD and
8 the Bonds, including, but not limited to, levying and collecting the Special Taxes, the fees and
9 expenses of legal counsel, charges levied by the City, including the Controller’s Office, the
10 Treasurer and Tax Collector’s Office, the City Attorney, and the Port, costs related to property
11 owner inquiries regarding the Special Taxes, costs associated with appeals or requests for
12 interpretation associated with the Special Taxes and this RMA, costs associated with
13 annexation of property into the STD, amounts needed to pay rebate to the federal government
14 with respect to the Bonds, costs associated with complying with any continuing disclosure
15 requirements for the City and any other major property owner (whether or not deemed to be an
16 obligated person), costs associated with foreclosure and collection of delinquent Special Taxes,
17 and all other costs and expenses of the City in any way related to the establishment or
18 administration of the STD.

19

20 **“Administrator”** means the Director of the Office of Public Finance or his/her designee who
21 shall be responsible for administering the Special Taxes according to this RMA.

22

23 **“Affordable Housing Project”** means a residential or primarily residential project, as
24 determined by the Review Authority, within which 100% of the residential units are Affordable
25 Units.

1 **“Affordable Unit”** means a Rental Unit for which a deed restriction has been recorded that (i)
2 limits the rental rates on the unit or (ii) in any other way is intended to restrict the current or
3 future value of the unit, as determined by the Review Authority.

4
5 **“Affordable Unit Leasehold Interest”** means a Leasehold Interest associated exclusively
6 with Affordable Units in a building that: (i) is not an Affordable Housing Project, and (ii) within
7 which there is also a Market-Rate Unit Leasehold Interest.

8
9 **“Appendix”** means the Appendix to Transaction Documents for the Pier 70 28-Acre Site
10 Project.

11
12 **“Arts Building Costs”** means up to \$20 million in costs (or such other amount identified in
13 the Financing Plan) associated with the Arts Building, the Noonan Replacement Space and
14 community facilities allocated under the Financing Plan, and authorized by the formation
15 proceedings for the STD, the Condo STD No. 2019-1, and the Financing Plan to be financed
16 by the Arts Building Special Tax and Arts Building Special Tax Bonds.

17
18 **“Arts Building Special Tax”** means a special tax levied in any Fiscal Year on a Leasehold
19 Interest in a Taxable Parcel to pay the Arts Building Special Tax Requirement.

20
21 **“Arts Building Special Tax Bonds”** means any Bonds secured by the Arts Building Special
22 Taxes that are issued to pay Arts Building Costs.

23
24 **“Arts Building Special Tax Requirement”** means the amount necessary in any Fiscal Year
25 to pay: (i) pay principal and interest on Arts Building Special Tax Bonds that are due in the

1 calendar year that begins in such Fiscal Year; (ii) pay periodic costs on Arts Building Special
2 Tax Bonds, including but not limited to, credit enhancement, liquidity support and rebate
3 payments; (iii) replenish reserve funds created for Arts Building Special Tax Bonds under the
4 Indenture to the extent such replenishment has not been included in the computation of the
5 Arts Building Special Tax Requirement in a previous Fiscal Year; (iv) cure any delinquencies
6 in the payment of principal or interest on Arts Building Special Tax Bonds which have
7 occurred in the prior Fiscal Year; (v) pay Administrative Expenses; (vi) pay other obligations
8 described in the Financing Plan; and (vii) pay directly for Arts Building Costs. The amount
9 calculated to pay items (i) through (vii) above may be reduced in any Fiscal Year by: (a)
10 interest earnings on or surplus balances in funds and accounts for the Arts Building Special
11 Tax Bonds to the extent that such earnings or balances are available to apply against such
12 costs pursuant to the Indenture; (b) in the sole and absolute discretion of the Port, proceeds
13 received by the STD from the collection of penalties associated with delinquent Arts Building
14 Special Taxes; and (c) any other revenues available to pay such costs, as determined by the
15 Administrator, the City, and the Port.

16
17 **“Assessed Parcel”** means, in any Fiscal Year, any Taxable Parcel that meets all five of the
18 following conditions: (i) there is a building on the Taxable Parcel for which a Certificate of
19 Occupancy has been issued; (ii) based on all information available to the Administrator, the
20 Baseline Assessed Value has been determined for the Taxable Parcel; (iii) ad valorem taxes
21 have been levied on the Taxable Parcel based on the Baseline Assessed Value of the building;
22 (iv) by the end of the prior Fiscal Year, at least one year of ad valorem taxes based upon the
23 Baseline Assessed Value of the building have been paid; and (v) the Taxable Parcel does not
24 have outstanding delinquencies in the payment of ad valorem property taxes or Special Taxes
25 at the latest point at which the Administrator is able to receive delinquency information from the

1 County prior to submitting the Facilities Special Tax levy in any Fiscal Year. Once a Taxable
2 Parcel has been categorized as an Assessed Parcel, such Taxable Parcel shall always be
3 considered an Assessed Parcel regardless of increases or decreases in assessed value.
4

5 **“Assessor’s Parcel”** or **“Parcel”** means a lot or parcel shown on an Assessor’s Parcel Map
6 with an assigned Assessor’s Parcel number.
7

8 **“Assessor’s Parcel Map”** means an official map of the County Assessor designating Parcels
9 by Assessor’s Parcel number.
10

11 **“Authorized Expenditures”** means, separately with respect to the Facilities Special Tax, Arts
12 Building Special Tax, Shoreline Special Tax, and Services Special Tax, those costs, facilities
13 or public services authorized to be funded by the applicable Special Tax as set forth in the
14 Financing Plan and the documents adopted by the Board at STD Formation, as may be
15 amended from time to time.
16

17 **“Base Arts Building Special Tax”** means, for any Square Footage Category, the per-square-
18 foot Arts Building Special Tax for Square Footage within such Square Footage Category, as
19 identified in Table 3 in Section C below, that can be levied on a Leasehold Interest in a Taxable
20 Parcel.
21

22 **“Base Facilities Special Tax”** means, for any Square Footage Category, the per-square-foot
23 Facilities Special Tax for Square Footage within such Square Footage Category, as identified
24 in Table 1 in Section C below, that can be levied on a Leasehold Interest in a Taxable Parcel.
25

1 **“Base Services Special Tax”** means, for any Square Footage Category, the per-square-foot
2 Services Special Tax for Square Footage within such Square Footage Category, as identified
3 in Table 4 in Section C below, that can be levied on a Leasehold Interest in a Taxable Parcel.

4
5 **“Base Shoreline Special Tax”** means, for any Square Footage Category, the per-square-
6 foot Shoreline Special Tax for Square Footage within such Square Footage Category, as
7 identified in Table 2 in Section C below, that can be levied on a Leasehold Interest in a
8 Taxable Parcel.

9
10 **“Base Special Tax”** means, collectively, the Base Facilities Special Tax, the Base Shoreline
11 Special Tax, the Base Arts Building Special Tax, and the Base Services Special Tax.

12
13 **“Baseline Assessed Value”** means, after a Certificate of Occupancy has been issued for a
14 Taxable Parcel, the assessed value that the Port and Vertical Developer mutually agree is the
15 final, unappealable value for the Taxable Parcel.

16
17 **“Board”** means the Board of the City, acting as the legislative body of STD No. 2019-2.

18
19 **“Bond Sale”** means, for the Facilities Special Tax, issuance of the any Facilities Special Tax
20 Bonds, for the Arts Building Special Tax, issuance of any Arts Building Special Tax Bonds,
21 and, for the Shoreline Special Tax, issuance of any Shoreline Special Tax Bonds.

22
23 **“Bonds”** means bonds or other debt (as defined in the CFD Law), whether in one or more
24 series, that are issued or assumed by or for the STD to finance Authorized Expenditures
25 including any Arts Building Special Tax Bonds, Facilities Special Tax Bonds, and Shoreline

1 Special Tax Bonds. The term “Bonds” includes any promissory note executed by or on behalf
2 of STD No. 2019-2 for the benefit of the Port.

3
4 **“Building Height”** means the proposed height of a Rental Residential Building, as set forth
5 on the Building Permit issued for the building, or if the height is not clearly indicated on the
6 Building Permit, the height determined by reference to the Vertical DDA, condominium plan,
7 or architectural drawings for the Rental Residential Building. If there is any question as to the
8 Building Height of any Rental Residential Building in the STD, the Administrator shall
9 coordinate with the Review Authority to make the determination, and such determination shall
10 be conclusive and binding.

11
12 **“Building Permit”** means (i) for Historic Buildings 2, 12 and 21, a permit issued by the Port
13 that allows for rehabilitation of the existing historic structures, and (ii) for all other structures, a
14 permit issued by the Port that allows for vertical construction of a building or buildings,
15 including any addendum to a site permit, but excluding a separate permit issued for
16 construction of building foundations.

17 **“Capitalized Interest”** means funds in any capitalized interest account available to pay debt
18 service on Bonds.

19
20 **“Certificate of Occupancy”** means the first certificate, including any temporary certificate of
21 occupancy, issued by the Port to confirm that a building or a portion of a building has met all
22 of the building codes and can be occupied for residential or non-residential use. For purposes
23 of this RMA, “Certificate of Occupancy” shall not include any certificate of occupancy that was
24 issued prior to January 1, 2018 for a building within the STD; however, any subsequent
25 certificates of occupancy that are issued for new construction, historic rehabilitation, or

1 expansion of a building shall be deemed a Certificate of Occupancy and the Special Taxes
2 shall apply to the associated Square Footage. For Historic Building 2, Historic Building 12,
3 and Historic Building 21, only a certificate of occupancy issued in association with the
4 permanent reuse of the building (as determined by the Port) shall qualify as a "Certificate of
5 Occupancy" for purposes of this RMA.

6
7 **"CFD Law"** means the San Francisco Special Tax Financing Law (Admin. Code ch. 43, art.
8 X), which incorporates the Mello-Roos Act.

9
10 **"City"** means the City and County of San Francisco, California.

11
12 **"Condo STD No. 2019-1"** means the City and County of San Francisco Special Tax District
13 No. 2019-1 (Pier 70 Condominiums).

14
15 **"County"** means the City and County of San Francisco, California.

16
17 **"D4D"** means the Pier 70 Special Use District Design for Development, dated May 22, 2018,
18 and as amended from time to time.

19
20 **"D4D Gross Floor Area"** means the square footage of a building determined pursuant to the
21 definition of "Gross Floor Area" in the D4D.

22
23 **"DDA"** means the Disposition and Development Agreement between the Port and the
24 Developer, including all exhibits and attachments, as may be amended from time to time.

1 **“Deputy Director”** means the Deputy Director of Finance and Administration for the Port or
2 other such official that acts as the chief financial officer for the Port.

3
4 **“Developed Property”** means, in any Fiscal Year, the following:

5 *For levy of the Facilities Special Tax and Arts Building Special Tax:* all Taxable Parcels
6 for which the 24-month anniversary of the VDDA Execution Date has occurred in a
7 preceding Fiscal Year, regardless of whether a Building Permit has been issued. For any
8 Taxable Parcel on which a structure is built and occupied without execution of a VDDA,
9 such Taxable Parcel shall be categorized as Developed Property in the Fiscal Year in
10 which a Certificate of Occupancy was issued on or prior to June 30 of the preceding
11 Fiscal Year.

12
13 *For levy of the Shoreline Special Tax and Services Special Tax:* all Taxable Parcels in a
14 building for which a Certificate of Occupancy was issued on or prior to June 30 of the
15 preceding Fiscal Year, but not prior to January 1, 2018.

16
17 **“Developer”** means FC Pier 70, LLC, or any successor or assign that takes over as tenant
18 under the Master Lease.

19
20 **“Development Approval Documents”** means, collectively, the DDA, any Vertical DDA, any
21 Final Maps, Review Authority approvals, or other such approved or recorded document or
22 plan that identifies the type of structures, acreage, and Square Footage approved for
23 development on Taxable Parcels.

1 **“Escalator”** means the lesser of the following: (i) the annual increase, if any, in the Consumer
2 Price Index (CPI) for All Urban Consumers in the San Francisco-Oakland-Hayward region
3 (base years 1982-1984=100) published by the Bureau of Labor Statistics of the United States
4 Department of Labor, or, if such index is no longer published, a similar escalator that is
5 determined by the Port and City to be appropriate, and (ii) five percent (5%).
6

7 **“Estimated Base Arts Building Special Tax Revenues”** means, at any point in time, the
8 amount calculated by the Administrator by multiplying the Base Arts Building Special Tax by
9 Square Footage within each Square Footage Category proposed for development and, if
10 applicable, already in completed buildings on a Taxable Parcel.
11

12 **“Estimated Base Facilities Special Tax Revenues”** means, at any point in time, the amount
13 calculated by the Administrator by multiplying the Base Facilities Special Tax by Square
14 Footage within each Square Footage Category proposed for development and, if applicable,
15 already in completed buildings on a Taxable Parcel.
16

17 **“Estimated Base Shoreline Special Tax Revenues”** means, at any point in time, the
18 amount calculated by the Administrator by multiplying the Base Shoreline Special Tax by
19 Square Footage within each Square Footage Category proposed for development and, if
20 applicable, already in completed buildings on a Taxable Parcel.
21

22 **“Exempt Child Care Square Footage”** means, for any building on a Parcel of Developed
23 Property, the square footage of child care uses that qualifies for exemption from the Special
24 Taxes, as determined by the Review Authority after review and consideration of the criteria
25 and requirements set forth in the D4D, VDDA, and DDA. After the First Bond Sale and

1 notwithstanding the foregoing, the designation of Exempt Child Care Square Footage shall
2 only be permitted to the extent such designation does not cause debt service coverage on
3 outstanding Bonds to be reduced below the Required Coverage. The Administrator and the
4 Review Authority will maintain a record of the amount and location of Exempt Child Care
5 Square Footage within each building in the STD. If, in any Fiscal Year, the Administrator
6 determines that square footage that had been designated as Exempt Child Care Square
7 Footage no longer meets the definition set forth above, such square footage shall be assigned
8 by the Review Authority to the appropriate Square Footage Category and taxed accordingly
9 pursuant to this RMA.

10
11 **“Exempt Parking Square Footage”** means, prior to the First Bond Sale, any square footage
12 in or expected in a building on a Parcel of Developed Property that is determined by the
13 Review Authority to be reserved for automobile or bicycle parking. After the First Bond Sale,
14 “Exempt Parking Square Footage” for any building on a Parcel of Developed Property shall be
15 the sum of following, as determined by the Review Authority:

- 16
17 1. Square footage in or expected in the building that, at the time the Parcel became
18 Developed Property, was determined by the Review Authority to be reserved for automobile
19 or bicycle parking; and
20
21 2. Square footage in or expected in the building that (i) exceeds the original Exempt
22 Square Footage determined when the Parcel became Developed Property, and (ii) if
23 exempted from Special Taxes, would not reduce coverage on outstanding Bonds below the
24 Required Coverage.
25

1 The Administrator and the Review Authority will maintain a record of the amount and location
2 of Exempt Parking Square Footage within each building in the STD. If, in any Fiscal Year, the
3 Administrator determines that square footage that had been designated as Exempt Parking
4 Square Footage no longer meets the definition set forth above, such square footage shall be
5 assigned by the Review Authority to the appropriate Square Footage Category and taxed
6 accordingly pursuant to this RMA.

7
8 **“Expected Land Uses”** means the total Square Footage in each Square Footage Category
9 expected on each Planning Parcel in the STD. The Expected Land Uses at STD Formation
10 are identified in Attachment 3 and may be revised pursuant to Sections B, C, D, and E below.

11
12 **“Expected Maximum Arts Building Special Tax Revenues”** means the aggregate Arts
13 Building Special Tax that can be levied based on application of the Base Arts Building Special
14 Tax to the Expected Land Uses. The Expected Maximum Arts Building Special Tax
15 Revenues for each Planning Parcel at STD Formation are shown in Attachment 3 and may be
16 revised pursuant to Sections B, C, D, and E below.

17
18 **“Expected Maximum Facilities Special Tax Revenues”** means the aggregate Facilities
19 Special Tax that can be levied based on application of the Base Facilities Special Tax to the
20 Expected Land Uses. The Expected Maximum Facilities Special Tax Revenues for each
21 Planning Parcel at STD Formation are shown in Attachment 3 and may be revised pursuant to
22 Sections B, C, D, and E below.

23 **“Expected Maximum Shoreline Special Tax Revenues”** means the aggregate Shoreline
24 Special Tax that can be levied based on application of the Base Shoreline Special Tax to the
25 Expected Land Uses. The Expected Maximum Shoreline Special Tax Revenues for each

1 Planning Parcel at STD Formation are shown in Attachment 3 and may be revised pursuant to
2 Sections B, C, D, and E below.

3
4 **“Facilities Special Tax”** means a special tax levied in any Fiscal Year on a Leasehold
5 Interest in a Taxable Parcel to pay the Facilities Special Tax Requirement.

6
7 **“Facilities Special Tax Bonds”** means any Bonds secured by Facilities Special Taxes.

8
9 **“Facilities Special Tax Requirement”** means the amount necessary in any Fiscal Year to: (i)
10 pay principal and interest on Facilities Special Tax Bonds that are due in the calendar year
11 that begins in such Fiscal Year; (ii) pay periodic costs on Facilities Special Tax Bonds,
12 including but not limited to, credit enhancement, liquidity support and rebate payments; (iii)
13 replenish reserve funds created for Facilities Special Tax Bonds under the Indenture to the
14 extent such replenishment has not been included in the computation of the Facilities Special
15 Tax Requirement in a previous Fiscal Year; (iv) cure any delinquencies in the payment of
16 principal or interest on Facilities Special Tax Bonds which have occurred in the prior Fiscal
17 Year; (v) in any Fiscal Year in which there is a Facilities Special Tax levied on one or more
18 Parcels pursuant to Step 1d. in Section F below, pay the fee imposed by the City for levying
19 such Facilities Special Tax on the County tax roll; (vi) pay other obligations described in the
20 Financing Plan; and (vii) pay directly for Authorized Expenditures, so long as such levy under
21 this clause (vii) does not increase the Facilities Special Tax levied on Undeveloped Property.
22 The amount calculated to pay items (i) through (vii) above may be reduced in any Fiscal Year
23 by: (a) interest earnings on or surplus balances in funds and accounts for the Facilities
24 Special Tax Bonds to the extent that such earnings or balances are available to apply against
25 such costs pursuant to the Indenture; (b) in the sole and absolute discretion of the Port,

1 proceeds received by the STD from the collection of penalties associated with delinquent
2 Facilities Special Taxes; and (c) any other revenues available to pay such costs, as
3 determined by the Administrator, the City, and the Port.
4

5 **“FC Project Area”** is defined in the Appendix.
6

7 **“Final Map”** means a final map, or portion thereof, recorded by the County pursuant to the
8 Subdivision Map Act (California Government Code Section 66410 *et seq.*) that creates
9 individual lots on which Building Permits for new construction or historic rehabilitation may be
10 issued without further subdivision.
11

12 **“Financing Plan”** means the Financing Plan attached as Exhibit C1 and incorporated into the
13 DDA, as such plan may be amended or supplemented from time to time in accordance with
14 the terms of the DDA.
15

16 **“First Bond Sale”** means, (i) for the Facilities Special Tax, a Bond Sale of the first series of
17 Facilities Special Tax Bonds, (ii) for the Arts Building Special Tax, a Bond Sale of the first series
18 of Arts Building Special Tax Bonds, and (iii) for the Shoreline Special Tax, a Bond Sale of the
19 first series of Shoreline Special Tax Bonds.
20

21 **“Fiscal Year”** means the period starting July 1 and ending on the following June 30.
22

23 **“Future Annexation Area”** means that geographic area that, at STD Formation, was
24 considered potential annexation area for the STD and which was, therefore, identified as “future
25 annexation area” on the recorded STD boundary map. Such designation does not mean that

1 any or all of the Future Annexation Area will annex into the STD, but should owners of property
2 designated as Future Annexation Area choose to annex, the annexation may be processed
3 pursuant to the annexation procedures in the CFD Law for territory included in a future
4 annexation area, as well as the procedures established by the Board and any other applicable
5 provisions of the CFD Law.

6
7 **“Historic Building 2”** means Building 2, which is classified as a significant contributing historic
8 resource to the Union Iron Works Historic District.

9
10 **“Historic Building 12”** means Building 12, which is classified as a significant contributing
11 historic resource to the Union Iron Works Historic District.

12
13 **“Historic Building 21”** means Building 21, which is classified as a significant contributing
14 historic resource to the Union Iron Works Historic District.

15
16 **“Indenture”** means any indenture, fiscal agent agreement, resolution, or other instrument
17 pursuant to which Bonds are issued, as modified, amended, or supplemented from time to time,
18 and any instrument replacing or supplementing the same.

19
20 **“Land Use Change”** means a change to the Expected Land Uses after STD
21 Formation.

22
23 **“Leasehold Interest”** means a Master Lease, ground lease, or any other lease
24 arrangement of a Parcel or Parcels against which Special Taxes may be levied in any
25 current or future Fiscal Year. The Review Authority shall make the final determination as to

1 whether a Parcel or building in the STD is subject to a Leasehold Interest for purposes of this
2 RMA.

3
4 **“Market-Rate Unit”** means a Rental Unit that is not an Affordable Unit.

5
6 **“Market-Rate Unit Leasehold Interest”** means a Leasehold Interest associated exclusively
7 with Market-Rate Units in a building within which there is also an Affordable Unit Leasehold
8 Interest.

9
10 **“Master Lease”** means a lease for all or part of the 28-Acre Site that, with licenses for other
11 portions of Pier 70, allows the Developer to take possession of the FC Project Area and
12 construct horizontal improvements approved under the DDA.

13
14 **“Maximum Arts Building Special Tax”** means the greatest amount of Arts Building Special
15 Tax that can be levied on a Leasehold Interest in a Taxable Parcel in any Fiscal Year
16 determined in accordance with Sections C, D, and E below.

17
18 **“Maximum Arts Building Special Tax Revenues”** means, at any point in time, the aggregate
19 Maximum Arts Building Special Tax that can be levied on all Leasehold Interests in all Taxable
20 Parcels.

21
22 **“Maximum Facilities Special Tax”** means the greatest amount of Facilities Special Tax that
23 can be levied on a Leasehold Interest in a Taxable Parcel in any Fiscal Year determined in
24 accordance with Sections C, D, and E below.

1 **“Maximum Facilities Special Tax Revenues”** means, at any point in time, the aggregate
2 Maximum Facilities Special Tax that can be levied on all Leasehold Interests in all Taxable
3 Parcels.

4
5 **“Maximum Services Special Tax”** means the greatest amount of Services Special Tax that
6 can be levied on a Leasehold Interest in a Taxable Parcel in any Fiscal Year determined in
7 accordance with Sections C, D, and E below.

8
9 **“Maximum Services Special Tax Revenues”** means, at any point in time, the aggregate
10 Maximum Services Special Tax that can be levied on all Leasehold Interests in all Taxable
11 Parcels.

12
13 **“Maximum Shoreline Special Tax”** means the greatest amount of Shoreline Special Tax that
14 can be levied on a Leasehold Interest in a Taxable Parcel in any Fiscal Year determined in
15 accordance with Sections C, D, and E below.

16
17 **“Maximum Shoreline Special Tax Revenues”** means, at any point in time, the aggregate
18 Maximum Shoreline Special Tax that can be levied on all Leasehold Interests in all Taxable
19 Parcels.

20
21 **“Maximum Special Tax”** means, for any Leasehold Interest in a Taxable Parcel in any Fiscal
22 Year, the sum of the Maximum Facilities Special Tax, Maximum Shoreline Special Tax,
23 Maximum Arts Building Special Tax, and Maximum Services Special Tax.

1 **“Maximum Special Tax Revenues”** means, collectively, the Maximum Facilities Special Tax
2 Revenues, Maximum Shoreline Special Tax Revenues, Maximum Arts Building Special Tax
3 Revenues, and Maximum Services Special Tax Revenues.

4
5 **“Mello-Roos Act”** means the Mello-Roos Community Facilities Act of 1982, as amended, being
6 Chapter 2.5, (commencing with Section 53311), Part 1, Division 2 of Title 5 of the Government
7 Code of the State of California.

8
9 **“Non-Residential Building”** means any building within the STD that is not a Rental Residential
10 Building, Historic Building 2, Historic Building 12, Historic Building 21, or part of an Affordable
11 Housing Project, as determined by the Review Authority.

12
13 **“Parcel Increment”** means, in any Fiscal Year, the amount of Tax Increment and funds from
14 any tax increment reserve fund maintained by the City that the Deputy Director has determined,
15 pursuant to the Financing Plan, is available to reduce the amount of Facilities Special Tax levied
16 against Assessed Parcels.

17
18 **“Planning Code”** means the Planning Code of the City and County of San Francisco, as it may
19 be amended from time to time.

20
21 **“Planning Parcel”** means a geographic area within the STD that, for planning and entitlement
22 purposes, has been designated as a separate Parcel with an alpha, numeric, or alpha-numeric
23 identifier to be used for reference until an Assessor’s Parcel is created and an Assessor’s Parcel
24 number is assigned. The Planning Parcels at STD Formation are identified in Attachment 1
25 hereto.

1 **“Port”** means the Port of San Francisco.

2
3 **“Proportionately”** means, for Developed Property, that the ratio of the actual Services
4 Special Tax levied in any Fiscal Year to the Maximum Services Special Tax authorized to be
5 levied in that Fiscal Year is equal for all Parcels of Developed Property. For Undeveloped
6 Property, “Proportionately” means that the ratio of the actual Facilities Special Tax levied to
7 the Maximum Facilities Special Tax is equal for all Parcels of Undeveloped Property.

8
9 **“Public Property”** means any property within the boundaries of the STD that is owned by or
10 leased to the federal government, State of California, City, or public agency other than the Port.
11 Parcels of Public Property, and/or Leasehold Interests in Public Property, shall be taxed as
12 Developed Property or Undeveloped Property, as determined by the Administrator pursuant to
13 the definitions set forth in this RMA.

14
15 **“Remainder Special Taxes”** means, as calculated between September 1st and December 31st
16 of any Fiscal Year, any Facilities Special Tax, Shoreline Special Tax, and Arts Building Special
17 Tax revenues that were collected in the prior Fiscal Year and were not needed to: (i) pay debt
18 service on the applicable Facilities Special Tax Bonds, Shoreline Special Tax Bonds, or Arts
19 Building Special Tax Bonds that was due in the calendar year that begins in the Fiscal Year in
20 which the Remainder Special Taxes were levied; (ii) pay periodic costs on the applicable
21 Facilities Special Tax Bonds, Shoreline Special Tax Bonds, or Arts Building Special Tax Bonds,
22 including but not limited to, credit enhancement, liquidity support and rebate payments (iii)
23 replenish reserve funds created for the applicable Facilities Special Tax Bonds, Shoreline
24 Special Tax Bonds, or Arts Building Special Tax Bonds under the applicable Indenture; (iv) cure
25 any delinquencies in the payment of principal or interest on applicable Facilities Special Tax

1 Bonds, Shoreline Special Tax Bonds, or Arts Building Special Tax Bonds which have occurred
2 in the prior Fiscal Year; or (v) pay Administrative Expenses that have been incurred, or are
3 expected to be incurred, by the City or Port prior to the receipt of Facilities Special Tax,
4 Shoreline Special Tax or Arts Building Special Tax proceeds.

5
6 **“Rental Residential Building”** means any building in the STD within which any of the Square
7 Footage is used or is expected to be used for one or more of the following uses: (i) Rental Units,
8 (ii) any type of group or student housing that provides lodging for a week or more and may or
9 may not have individual cooking facilities, including but not limited to boarding houses,
10 dormitories, housing operated by medical institutions, and single room occupancy units, or (iii)
11 a residential care facility that is not staffed by licensed medical professionals. The Review
12 Authority shall make the determination as to whether a building in the STD is a Rental
13 Residential Building.

14
15 **“Rental Unit”** means an individual residential housing unit in a residential or mixed-use building
16 within which all of the residential units are offered for rent to the general public and are not
17 available for sale to or ownership by individual homebuyers.

18
19 **“Required Coverage”** means (i) for Arts Building Special Tax Bonds, the amount by which
20 the Maximum Arts Building Special Tax Revenues must exceed the Arts Building Special
21 Tax Bond debt service and priority Administrative Expenses (if any), as set forth in the
22 applicable Indenture, Certificate of Special Tax Consultant, or other STD Formation
23 Proceedings or Bond document that sets forth the minimum required debt service coverage;
24 (ii) for Facilities Special Tax Bonds, the amount by which the Maximum Facilities Special Tax
25 Revenues must exceed the Facilities Special Tax Bond debt service, as set forth in the

1 applicable Indenture, Certificate of Special Tax Consultant, or other STD Formation
2 Proceedings or Bond document that sets forth the minimum required debt service coverage;
3 and (iii) for Shoreline Special Tax Bonds, the amount by which the Maximum Shoreline
4 Special Tax Revenues must exceed the Shoreline Special Tax Bond debt service and priority
5 Administrative Expenses (if any), as set forth in the applicable Indenture, Certificate of
6 Special Tax Consultant, or other STD Formation Proceedings or Bond document that sets
7 forth the minimum required debt service coverage.

8
9 **“Review Authority”** means the Deputy Director of Real Estate & Development for the Port or
10 an alternate designee from the Port or the City who is responsible for approvals and
11 entitlements of a development project.

12
13 **“RMA”** means this Rate and Method of Apportionment of Special Taxes.

14
15 **“Services Special Tax”** means a special tax levied in any Fiscal Year on a Leasehold Interest
16 in a Taxable Parcel to pay the Services Special Tax Requirement.

17
18 **“Services Special Tax Requirement”** means the amount necessary in any Fiscal Year to: (i)
19 pay the costs of operations and maintenance or other public services that are included as
20 Authorized Expenditures; (ii) cure delinquencies in the payment of Services Special Taxes in
21 the prior Fiscal Year; and (iii) pay Administrative Expenses.

22
23 **“Shoreline Special Tax”** means a special tax levied in any Fiscal Year to pay the Shoreline
24 Special Tax Requirement.

1 **“Shoreline Special Tax Bonds”** means any Bonds secured by Shoreline Special Taxes that
2 have been levied and are available after dividing the Shoreline Special Taxes as set forth in
3 Financing Plan Section 4.7(b), and factoring in debt service coverage and related Indenture
4 requirements, as determined by the Administrator

5
6 **“Shoreline Special Tax Requirement”** means the amount necessary in any Fiscal Year to
7 pay: (i) pay principal and interest on Shoreline Special Tax Bonds that are due in the calendar
8 year that begins in such Fiscal Year; (ii) pay periodic costs on Shoreline Special Tax Bonds,
9 including but not limited to, credit enhancement, liquidity support and rebate payments; (iii)
10 replenish reserve funds created for Shoreline Special Tax Bonds under the Indenture to the
11 extent such replenishment has not been included in the computation of the Shoreline Special
12 Tax Requirement in a previous Fiscal Year; (iv) cure any delinquencies in the payment of
13 principal or interest on Shoreline Special Tax Bonds which have occurred in the prior Fiscal
14 Year; (v) pay Administrative Expenses; (vi) pay directly for the costs of shoreline improvements;
15 and (vii) pay other obligations described in the Financing Plan. The amount calculated to pay
16 items (i) through (vii) above may be reduced in any Fiscal Year by: (a) interest earnings on or
17 surplus balances in funds and accounts for the Shoreline Special Tax Bonds to the extent that
18 such earnings or balances are available to apply against such costs pursuant to the Indenture;
19 (b) in the sole and absolute discretion of the Port, proceeds received by the STD from the
20 collection of penalties associated with delinquent Shoreline Special Taxes; and (c) any other
21 revenues available to pay such costs, as determined by the Administrator, the City, and the
22 Port.

1 **“Special Taxes”** means:

2 *For Tax Zones 1 and 2:* the Facilities Special Tax, Shoreline Special Tax, Arts Building
3 Special Tax, and Services Special Tax.

4
5 *For Tax Zone 3:* the Facilities Special Tax.

6
7 **“Square Footage”** means the square footage within a building on a Taxable Parcel determined
8 by the Review Authority pursuant to the following steps:

9
10 *Step 1.* Determine the D4D Gross Floor Area for the building.

11
12 *Step 2.* Subtract all Exempt Child Care Square Footage.

13
14 *Step 3.* Subtract all Exempt Parking Square Footage.

15
16 *Step 4.* Add the square footage of all retail (including retail on the same floor as a rooftop
17 park), cultural, educational, recreational, religious, and social service uses.

18
19 If a Building Permit is issued that will increase the Square Footage on a Taxable Parcel,
20 the Administrator shall, in the first Fiscal Year after the final Building Permit inspection
21 has been conducted in association with such expansion, work with the Review Authority
22 to recalculate (i) the Square Footage on the Taxable Parcel, and (ii) the Maximum
23 Special Taxes for the Taxable Parcel based on the increased Square Footage. If an
24 Affordable Unit Leasehold Interest is established within a Rental Residential Building,
25 the Square Footage of that Rental Residential Building shall be calculated using, for

1 purposes of Step 1 above, the D4D Gross Floor Area of the entire Rental Residential
2 Building, including the floor area associated with the Affordable Unit Leasehold Interest
3

4 The final determination of Square Footage within each building in the STD shall be made by
5 the Review Authority. After the First Bond Sale, the Square Footage within a building shall
6 never be revised in a manner that reduces Special Tax revenues such that debt service
7 coverage on outstanding Bonds is lower than the Required Coverage. "Square Foot" means a
8 single square-foot unit of Square Footage.
9

10 **"Square Footage Category"** means, individually, Square Footage within a Rental
11 Residential Building, Non-Residential Building, Historic Building 2, Historic Building 12, or
12 Historic Building 21.
13

14 **"STD"** or **"STD No. 2019-2"** means the City and County of San Francisco Special Tax
15 District No. 2019-2 (Pier 70 Leased Properties).
16

17 **"STD Formation"** means the date on which the Board approved documents to form the STD.
18

19 **"STD Formation Proceedings"** means the proceedings to form the STD, including all
20 resolutions, reports, and notices.
21

22 **"Sub-Project Area"** means a specific geographic area within the City and County of San
23 Francisco Infrastructure Financing District No. 2 (Port of San Francisco).
24
25

1 **“Taxable Child Care Square Footage”** means, after the First Bond Sale, any square footage
2 in a building that: (i) is used for operations of a licensed child care facility, and (ii) is not
3 Exempt Child Care Square Footage, as determined by the Review Authority.

4
5 **“Taxable Parking Square Footage”** means, after the First Bond Sale, any square footage in
6 a building that: (i) is used for parking, and (ii) is not Exempt Parking Square Footage, as
7 determined by the Review Authority.

8
9 **“Tax-Exempt Port Parcels”** means Port-owned Parcels that are or are intended to be used
10 as streets, walkways, alleys, rights of way, parks, open space, or other similar uses. The final
11 determination as to whether a Parcel is a Tax-Exempt Port Parcel shall be made by the
12 Review Authority.

13
14 **“Tax Increment”** means the tax increment generated from Sub-Project Areas G-2, G-3, and
15 G-4, as further defined in the Appendix.

16 **“Taxable Parcel”** means any Parcel within the STD that is not a Tax-Exempt Port Parcel or a
17 Parcel for which the Special Tax has been prepaid pursuant to Sections 53317.3 or 53317.5
18 of the Mello-Roos Act.

19
20 **“Taxpayer”** means the lessee of a Taxable Parcel within the STD.

21
22 **“Tax Zone”** means a separate and distinct geographic area in the STD within which one or
23 more Special Taxes are applied at a rate or in a manner that is different than in other areas
24 within the STD. The three Tax Zones at STD Formation are identified in Attachment 2 hereto.
25 The Port will designate the Tax Zone in which Parcels that annex into the STD will be placed.

1 **“Undeveloped Property”** means, in any Fiscal Year, all Taxable Parcels that are not
2 Developed Property.

3
4 **“VDDA Execution Date”** means the effective date of a Vertical DDA that was fully executed
5 by the Port and a Vertical Developer.

6
7 **“Vertical DDA”** means, for a Taxable Parcel, an executed Vertical Disposition and
8 Development Agreement between the Port and a Vertical Developer.

9
10 **“Vertical Developer”** means a developer that has entered into a Vertical DDA for
11 construction of vertical improvements or rehabilitation of an historic building on a Taxable
12 Parcel.

13
14 **B. DATA FOR STD ADMINISTRATION**

15
16 On or about July 1 of each Fiscal Year, the Administrator shall identify the current Assessor’s
17 Parcel numbers for all Taxable Parcels. The Administrator shall also determine: (i) whether
18 each Taxable Parcel is Developed Property or Undeveloped Property; (ii) the Planning Parcel
19 within which each Assessor’s Parcel is located; (iii) for Developed Property, the Building
20 Height and Square Footage of each Rental Residential Building and the Square Footage of
21 Historic Building 2, Historic Building 12, Historic Building 21, and each Non-Residential
22 Building; (iv) the Taxpayer for each Leasehold Interest in a Taxable Parcel; (v) if there are
23 Affordable Unit Leasehold Interests in any buildings within the STD; and (vi) the Facilities
24 Special Tax Requirement, Arts Building Special Tax Requirement, Shoreline Special Tax
25 Requirement, and Services Special Tax Requirement for the Fiscal Year.

1 The Administrator shall also: (i) coordinate with the Deputy Director to confirm Parcel Increment;
2 (ii) coordinate with the Treasurer-Tax Collector's Office to determine if there have been any
3 Special Tax delinquencies or repayment of Special Tax delinquencies in prior Fiscal Years; (iii)
4 review the Development Approval Documents and communicate with the Developer and
5 Vertical Developers regarding proposed Land Use Changes; and (iv) upon each annexation,
6 Land Use Change, and notification of Vertical DDA Execution Dates, update Attachment 3 to
7 reflect the then-current Expected Land Uses, Expected Maximum Facilities Special Tax
8 Revenues, Expected Maximum Shoreline Special Tax Revenues, and Expected Maximum Arts
9 Building Special Tax Revenues. The Developer, Port, or Vertical Developer shall notify the
10 Administrator each time a Vertical DDA is executed in order for the Administrator to keep track
11 of VDDA Execution Dates. In addition, the Port will: (i) provide the Administrator with copies of
12 all leases that establish a Leasehold Interest, (ii) notify the Administrator of renewals of leases
13 that establish a Leasehold Interest, and (iii) identify the buildings, Parcels, and Square Footage
14 subject to such leases that establish a Leasehold Interest. Any time a lease on property within
15 the STD is terminated, the Port will immediately notify the Administrator of such termination.

16
17 Prior to the First Bond Sale, the Administrator, Port, Developer, and any Vertical Developers
18 shall coordinate to review the Expected Land Uses and determine if changes should be made
19 to reflect more current estimates for land uses on each Planning Parcel. Based on this review,
20 the Administrator shall update Attachment 3 with the then-current Expected Land Uses and
21 Expected Maximum Facilities Special Tax Revenues, Expected Maximum Arts Building Special
22 Tax Revenues, and Expected Maximum Shoreline Special Tax Revenues, which will be used
23 to size the sale of Bonds unless and until there are additional updates of Attachment 3.

1 In any Fiscal Year, if it is determined that (i) a parcel map or condominium plan was recorded
2 after January 1 of the prior Fiscal Year (or any other date after which the Assessor will not
3 incorporate the newly-created Parcels into the then current tax roll), (ii) because of the date the
4 map or plan was recorded, the Assessor does not yet recognize the newly-created Parcels, and
5 (iii) one or more of the newly-created Parcels meets the definition of Developed Property, the
6 Administrator shall calculate the Special Taxes for the property affected by recordation of the
7 map or plan by determining the Special Taxes that applies separately to each newly-created
8 Parcel, then applying the sum of the individual Special Taxes to the Parcel that was subdivided
9 by recordation of the parcel map or condominium plan.

11 **C. MAXIMUM SPECIAL TAXES**

13 In calculating Maximum Special Taxes pursuant to this Section C, in any Fiscal Year in which
14 the boundaries of the Planning Parcels are not identical to the boundaries of the then-current
15 Assessor's Parcels, the Administrator shall review the Expected Land Uses for each Planning
16 Parcel and assign the Maximum Special Taxes to the then-current Assessor's Parcels. The
17 Maximum Special Tax Revenues after such allocation shall not be less than the Maximum
18 Special Tax Revenues prior to the allocation.

19 **1. *Undeveloped Property***

21 **1a. Facilities Special Tax**

23 The Maximum Facilities Special Tax for Leasehold Interests in Undeveloped Property in
24 all Tax Zones shall be the Expected Maximum Facilities Special Tax Revenues shown
25 in Attachment 3 of this RMA, as it may be amended as set forth herein.

1b. Shoreline Special Tax, Arts Building Special Tax, and Services Special Tax

No Shoreline Special Tax, Arts Building Special Tax, or Services Special Tax shall be levied on Parcels of Undeveloped Property in any Tax Zone within the STD.

2. Developed Property

2a. Facilities Special Tax

When a Taxable Parcel becomes Developed Property, the Administrator shall use the Base Facilities Special Taxes shown in Table 1 below and apply the steps set forth in this Section 2a to determine the Maximum Facilities Special Tax for Leasehold Interests in the Taxable Parcel:

Table 1 Base Facilities Special Tax			
Square Footage Category	Base Facilities Special Tax Tax Zone 1 (FY 2019-20) *	Base Facilities Special Tax Tax Zone 2 (FY 2019-20) *	Base Facilities Special Tax Tax Zone 3 (FY 2019-20) *
Square Footage in Rental Residential Buildings with Building Heights greater than 70 feet	\$3.96 per square foot	\$3.96 per square foot	N/A
Square Footage in Rental Residential Buildings with Building Heights less than or equal to 70 feet	\$3.73 per square foot	\$3.73 per square foot	N/A
Square Footage in Non-Residential Buildings	\$3.74 per square foot	\$3.74 per square foot	N/A
Square Footage in Historic Building 2	\$3.73 per square foot	N/A	N/A

Square Footage in Historic Building 12	N/A	N/A	\$3.52 per square foot
Square Footage in Historic Building 21	N/A	N/A	\$3.64 per square foot

*** The Base Facilities Special Tax shown above for each Tax Zone shall be escalated as set forth in Section D.1.**

Step 1. The Administrator shall review the Building Permit, Certificate of Occupancy, Vertical DDA, condominium plan, architectural drawings, Development Approval Documents, information provided by the Port, Developer or Vertical Developer, and any other documents or data that estimate or identify the Square Footage within each building on the Taxable Parcel.

Step 2. Using the information from Step 1:

- After consideration of the Building Height and Tax Zone for the Taxable Parcel, multiply the applicable Base Facilities Special Tax from Table 1 by the actual and/or expected Square Footage in each Rental Residential Building on the Taxable Parcel.

- Based on the Tax Zone in which the Taxable Parcel is located, multiply the applicable Base Facilities Special Tax from Table 1 by the actual and/or expected Square Footage in each Non-Residential Building on the Taxable Parcel.

- Multiply the applicable Base Facilities Special Tax from Table 1 by the actual and/or expected Square Footage of Historic Building 2, Historic Building 12, and Historic Building 21.

1 Prior to the First Bond Sale, the Maximum Facilities Special Tax for Leasehold Interests in the
2 Taxable Parcel shall be the sum of the amounts calculated above, and Steps 3 and 4 below
3 shall not apply.

4
5 After the First Bond Sale, the Administrator shall apply Steps 3 and 4 to determine the
6 Maximum Facilities Special Tax for Leasehold Interests in the Taxable Parcel.

7
8 *Step 3.* Sum the amounts calculated in Step 2 to determine the Estimated Base
9 Facilities Special Tax Revenues for Leasehold Interests in the Taxable Parcel.

10
11 *Step 4.* Compare the Estimated Base Facilities Special Tax Revenues
12 from Step 3 to the Expected Maximum Facilities Special Tax Revenues, and, apply one of the
13 following, as applicable:

14
15 ▪ *If the Estimated Base Facilities Special Tax Revenues are: (i) greater than or equal to*
16 *the Expected Maximum Facilities Special Tax Revenues or (ii) less than the Expected*
17 *Maximum Facilities Special Tax Revenues, but the Maximum Facilities Special Tax*
18 *Revenues, assuming the same land uses that went into the calculation of the Estimated Base*
19 *Facilities Special Tax Revenues, are still sufficient to provide Required Coverage, then the*
20 *Maximum Facilities Special Tax for Leasehold Interests in the Taxable Parcel shall be*
21 *determined by multiplying the applicable Base Facilities Special Taxes by the actual and/or*
22 *expected Square Footage within each building on the Taxable Parcel. The Administrator shall*
23 *update Attachment 3 to reflect the change in the Expected Maximum Facilities Special Tax*
24 *Revenues and the change in Maximum Facilities Special Tax Revenues.*

1 ▪ *If the Estimated Base Facilities Special Tax Revenues are less than the Expected*
2 *Maximum Facilities Special Tax Revenues, and the Maximum Facilities Special Tax*
3 *Revenues, assuming the same land uses that went into the calculation of the Estimated Base*
4 *Facilities Special Tax Revenues, are insufficient to provide Required Coverage, then the Base*
5 *Facilities Special Taxes that were applied in Step 2 shall be increased proportionately until the*
6 *amount that can be levied on Leasehold Interests in the Taxable Parcel, combined with the*
7 *Expected Maximum Facilities Special Tax Revenues from all other Taxable Parcels in the*
8 *STD, is sufficient to maintain Required Coverage.*

9
10 After proportionately increasing the Base Facilities Special Taxes to an amount that will
11 maintain Required Coverage, the Administrator shall use these adjusted per-square-foot rates
12 to calculate the Maximum Facilities Special Tax for each building on the Taxable Parcel. The
13 Administrator shall also revise Attachment 3 to reflect the new Expected Maximum Facilities
14 Special Tax Revenues.

15
16 If, in any Fiscal Year, the Maximum Facilities Special Tax is determined for Leasehold
17 Interests in any Parcel of Developed Property for which a Building Permit had not yet been
18 issued, and if, when a Building Permit is issued for a building(s) on the Parcel, the Square
19 Footage of such building(s) is different than the Square Footage that was used to determine
20 the Maximum Facilities Special Tax, then the Administrator shall once again apply Steps 1
21 through 4 in this Section C.2a to recalculate the Maximum Facilities Special Tax for Leasehold
22 Interests in the Parcel based on the Square Footage that was determined when the Building
23 Permit was issued. The Administrator shall do a final check of the Square Footage within
24 each building when a Certificate of Occupancy is issued. Once again, if the Square Footage
25 is different than the Square Footage that was used to determine the Maximum Facilities

Special Tax after the Building Permit was issued, then the Administrator shall apply Steps 1 through 4 in this Section C.2a to recalculate the Maximum Facilities Special Tax for Leasehold Interests in the Parcel.

2b. Shoreline Special Tax

Upon issuance of the first Certificate of Occupancy for a building on a Taxable Parcel, the Administrator shall reference Table 2 and apply the steps below to determine the Maximum Shoreline Special Tax for that particular building on the Taxable Parcel:

Table 2 Base Shoreline Special Tax			
Square Footage Category	Base Shoreline Special Tax Tax Zone 1 (FY 2019-20) *	Base Shoreline Special Tax Tax Zone 2 (FY 2019-20) *	Base Shoreline Special Tax Tax Zone 3 (FY 2019-20) *
Square Footage in Rental Residential Buildings with Building Heights greater than 70 feet	\$0.60 per square foot	\$0.91 per square foot	\$0.00 per square foot
Square Footage in Rental Residential Buildings with Building Heights less than or equal to 70 feet	\$0.57 per square foot	\$0.84 per square foot	\$0.00 per square foot
Square Footage in Non-Residential Buildings	\$0.57 per square foot	\$0.86 per square foot	\$0.00 per square foot
Square Footage in Historic Building 2	\$0.57 per square foot	\$0.00 per square foot	\$0.00 per square foot

*** The Base Shoreline Special Tax shown above for each Tax Zone shall be escalated as set forth in Section D.1.**

1 *Step 1.* Review the Certificate of Occupancy, Building Permit, Vertical DDA,
2 condominium plan, Development Approval Documents, architectural drawings, information
3 provided by the Port, Developer, or Vertical Developer, and coordinate with the Review
4 Authority to determine the Square Footage anticipated within the building for which a
5 Certificate of Occupancy was issued.

6
7 *Step 2.* Using the information from Step 1:

8
9 ▪ If the building for which a Certificate of Occupancy was issued is a Rental Residential
10 Building, after consideration of the Building Height and Tax Zone for the building, multiply the
11 applicable Base Shoreline Special Tax from Table 2 by the Square Footage expected within
12 the building.

13
14 ▪ If the building for which a Certificate of Occupancy was issued is a Non-Residential
15 Building, based on the Tax Zone within which the Taxable Parcel is located, multiply the
16 applicable Base Shoreline Special Tax from Table 2 by the Square Footage within the
17 building.

18
19 ▪ If the building for which a Certificate of Occupancy was issued is Historic Building 2,
20 multiply the applicable Base Shoreline Special Tax from Table 2 by the Square Footage within
21 Historic Building 2.

22
23 Prior to the First Bond Sale, the Maximum Shoreline Special Tax for Leasehold Interests in
24 the Taxable Parcel shall be the sum of the amounts calculated pursuant to the steps above for
25

1 each building on the Taxable Parcel for which a Certificate of Occupancy has been issued,
2 and Steps 3 and 4 below shall not apply.

3
4 After the First Bond Sale, the Administrator shall apply Steps 3 and 4 to determine the
5 Maximum Shoreline Special Tax for Leasehold Interests in the Taxable Parcel.

6
7 *Step 3.* Sum the amounts calculated pursuant to the steps above for all buildings on the
8 Taxable Parcel for which Certificates of Occupancy have been issued, and estimate the
9 Shoreline Special Taxes to be generated from any remaining buildings expected to be
10 constructed on the Taxable Parcel, to determine the Estimated Base Shoreline Special Tax
11 Revenues for the Taxable Parcel.

12
13 *Step 4.* Compare the Estimated Base Shoreline Special Tax Revenues from Step 3 to
14 the Expected Maximum Shoreline Special Tax Revenues, and, apply one of the following, as
15 applicable:

16
17 ▪ *If the Estimated Base Shoreline Special Tax Revenues are: (i) greater than or equal to*
18 *the Expected Maximum Shoreline Special Tax Revenues or (ii) less than the Expected*
19 *Maximum Shoreline Special Tax Revenues, but the Maximum Shoreline Special Tax*
20 *Revenues, assuming the same land uses that went into the calculation of the Estimated Base*
21 *Shoreline Special Tax Revenues, are still sufficient to provide Required Coverage and to meet*
22 *the requirements of Financing Plan Section 4.7, then the Maximum Shoreline Special Tax for*
23 *Leasehold Interests in the Taxable Parcel shall be determined by multiplying the applicable*
24 *Base Shoreline Special Taxes by the Square Footage expected on each building on the*
25 *Taxable Parcel. The Administrator shall update Attachment 3 to reflect the change in the*

Expected Maximum Shoreline Special Tax Revenues and the change in Maximum Shoreline Special Tax Revenues.

▪ *If the Estimated Base Shoreline Special Tax Revenues are less than the Expected Maximum Shoreline Special Tax Revenues, and the Maximum Shoreline Special Tax Revenues, assuming the same land uses that went into the calculation of the Estimated Base Shoreline Special Tax Revenues, are insufficient to provide Required Coverage and to meet the requirements of Financing Plan Section 4.7, then the Base Shoreline Special Taxes that were applied in Step 2 shall be increased proportionately until the amount that can be levied on Leasehold Interests in the Taxable Parcel, combined with the Expected Maximum Shoreline Special Tax Revenues from all other Taxable Parcels in the STD, is sufficient to maintain Required Coverage.*

After proportionately increasing the Base Shoreline Special Taxes to an amount that will maintain Required Coverage, the Administrator shall use these adjusted per-square-foot rates to calculate the Maximum Shoreline Special Tax for each building on the Taxable Parcel. The Administrator shall also revise Attachment 3 to reflect the new Expected Maximum Shoreline Special Tax Revenues.

If additional structures are anticipated to be built on the Taxable Parcel as shown in the Development Approval Documents, the Administrator shall, regardless of the definitions set forth herein, categorize each building for which a Certificate of Occupancy has been issued as Developed Property, and any remaining buildings for which Certificates of Occupancy have not yet been issued shall not be subject to a Shoreline Special Tax until a Certificate of Occupancy is issued for such remaining buildings. To determine the Shoreline Special Tax

for Leasehold Interests in any such Taxable Parcel, the Administrator shall take the sum of the Shoreline Special Taxes determined for each building.

2c. Arts Building Special Tax

When a Taxable Parcel becomes Developed Property, the Administrator shall use the Base Arts Building Special Taxes shown in Table 3 below and apply the steps set forth in this Section 2c to determine the Maximum Arts Building Special Tax for Leasehold Interests in the Taxable Parcel:

Table 3 Base Arts Building Special Tax			
Square Footage Category	Base Arts Building Special Tax Tax Zone 1 (FY 2019-20) *	Base Arts Building Special Tax Tax Zone 2 (FY 2019-20) *	Base Arts Building Special Tax Tax Zone 3 (FY 2019-20) *
Square Footage in Rental Residential Buildings with Building Heights greater than 70 feet	\$0.43 per square foot	\$0.43 per square foot	\$0.00 per square foot
Square Footage in Rental Residential Buildings with Building Heights less than or equal to 70 feet	\$0.43 per square foot	\$0.43 per square foot	\$0.00 per square foot
Square Footage in Non-Residential Buildings	\$0.53 per square foot	\$0.53 per square foot	\$0.00 per square foot
Square Footage in Historic Building 2	\$0.43 per square foot	\$0.00 per square foot	\$0.00 per square foot

*** The Base Arts Building Special Tax shown above for each Tax Zone shall be escalated as set forth in Section D.1.**

1 *Step 1.* The Administrator shall review the Building Permit, Certificate of
2 Occupancy, Vertical DDA, condominium plan, architectural drawings, Development Approval
3 Documents, information provided by the Port, Developer, or Vertical Developer, and any other
4 documents or data that estimate or identify the Square Footage within each building
5 anticipated on the Taxable Parcel.

6
7 *Step 2.* Using the information from Step 1:

8
9 ▪ After consideration of the Building Height and Tax Zone for the Taxable Parcel, multiply
10 the applicable Base Arts Building Special Tax from Table 3 by the actual and/or expected
11 Square Footage in each Rental Residential Building on the Taxable Parcel

12
13 ▪ Based on the Tax Zone in which the Taxable Parcel is located, multiply the applicable
14 Base Arts Building Special Tax from Table 3 by actual and/or expected the Square Footage
15 within each Non-Residential Building on the Taxable Parcel.

16 ▪ Multiply the applicable Base Arts Building Special Tax from Table 3 by the Square
17 Footage within Historic Building 2.

18
19 Prior to the First Bond Sale, the Maximum Arts Building Special Tax for the Taxable Parcel
20 shall be the sum of the amounts calculated above, and Steps 3 and 4 below shall not apply.

21
22 After the First Bond Sale, the Administrator shall apply Steps 3 and 4 to determine the
23 Maximum Arts Building Special Tax for Leasehold Interests in the Taxable Parcel.

1 Step 3. Sum the amounts calculated in Step 2 to determine the Estimated Base
2 Arts Building Special Tax Revenues for each Taxable Parcel

3
4 Step 4. Compare the Estimated Base Arts Building Special Tax Revenues from
5 Step 3 to the Expected Maximum Arts Building Special Tax Revenues, and apply one of the
6 following, as applicable:

7
8 ▪ *If the Estimated Base Arts Building Special Tax Revenues are: (i) greater than or equal*
9 *to the Expected Maximum Arts Building Special Tax Revenues or (ii) less than the Expected*
10 *Maximum Arts Building Special Tax Revenues, but the Maximum Arts Building Special Tax*
11 *Revenues, assuming the same land uses that went into the calculation of the Estimated Base*
12 *Arts Building Special Tax Revenues, are still sufficient to provide Required Coverage, then the*
13 *Maximum Arts Building Special Tax for Leasehold Interests in the Taxable Parcel shall be*
14 *determined by multiplying the applicable Base Arts Building Special Taxes by the actual*
15 *and/or expected Square Footage of each building on the Taxable Parcel. The Administrator*
16 *shall update Attachment 3 to reflect the change in Expected Maximum Arts Building Special*
17 *Tax Revenues and the change in Maximum Arts Building Special Tax Revenues.*

18
19 ▪ *If the Estimated Base Arts Building Special Tax Revenues are less than the Expected*
20 *Maximum Arts Building Special Tax Revenues, and the Maximum Arts Building Special Tax*
21 *Revenues, assuming the same land uses that went into the calculation of the Estimated Base*
22 *Arts Building Special Tax Revenues, are insufficient to provide Required Coverage, then the*
23 *Base Arts Building Special Taxes that were applied in Step 2 shall be increased*
24 *proportionately until the amount that can be levied on Leasehold Interests in the Taxable*
25

1 Parcel, combined with the Expected Maximum Arts Building Special Tax Revenues from all
2 other Taxable Parcels in the STD, is sufficient to maintain Required Coverage.

3
4 After proportionately increasing the Base Arts Building Special Taxes to an amount that will
5 maintain Required Coverage, the Administrator shall use these adjusted per-square foot rates
6 to calculate the Maximum Arts Building Special Tax for each building on the Taxable Parcel.
7 The Administrator shall also revise Attachment 3 to reflect the new Expected Maximum Arts
8 Building Special Tax Revenues.

9
10 If, in any Fiscal Year, the Maximum Arts Building Special Tax is determined for Leasehold
11 Interests in any Parcels of Developed Property for which a Building Permit had not yet been
12 issued and, if, when a Building Permit is issued for a building(s) on the Parcel, the Square
13 Footage of such building(s) is different than the Square Footage that was used to determine
14 the Maximum Arts Building Special Tax, then the Administrator shall once again apply Steps 1
15 through 4 in this Section C.2c to recalculate the Maximum Arts Building Special Tax for
16 Leasehold Interests in the Parcel based on the Square Footage that was determined when
17 the Building Permit was issued. The Administrator shall do a final check of the Square
18 Footage within each building when a Certificate of Occupancy is issued. Once again, if the
19 Square Footage is different than the Square Footage that was used to determine the
20 Maximum Arts Building Special Tax after the Building Permit was issued, then the
21 Administrator shall apply Steps 1 through 4 in this Section C.2c to recalculate the Maximum
22 Arts Building Special Tax for Leasehold Interests in the Parcel.

2d. **Services Special Tax**

Upon issuance of the first Certificate of Occupancy for a building on a Taxable Parcel, the Administrator shall reference Table 4 and apply the steps below to determine the Maximum Services Special Tax for that particular building on the Taxable Parcel:

Table 4 Base Services Special Tax			
Square Footage Category	Base Services Special Tax Tax Zone 1 (FY 2019-20) *	Base Services Special Tax Tax Zone 2 (FY 2019-20) *	Base Services Special Tax Tax Zone 3 (FY 2019-20) *
Square Footage in Rental Residential Buildings with Building Heights greater than 70 feet	\$0.87 per square foot	\$0.87 per square foot	\$0.00 per square foot
Square Footage in Rental Residential Buildings with Building Heights less than or equal to 70 feet	\$0.87 per square foot	\$0.87 per square foot	\$0.00 per square foot
Square Footage in Non-Residential Buildings	\$1.07 per square foot	\$1.07 per square foot	\$0.00 per square foot
Square Footage in Historic Building 2	\$0.87 per square foot	\$0.00 per square foot	\$0.00 per square foot

*** The Base Services Special Tax for each Tax Zone shown above shall be escalated as set forth in Section D.2.**

Step 1. Review the Certificate of Occupancy, Building Permit, Vertical DDA, condominium plan, Development Approval Documents, architectural drawings, information provided by the Port, Developer, or Vertical Developer, and coordinate with the Review

1 Authority to determine the Square Footage anticipated within the building for which a
2 Certificate of Occupancy was issued.

3
4 *Step 2.* Using the information from Step 1:

5
6 ▪ If the building for which a Certificate of Occupancy was issued is a Rental Residential
7 Building, after consideration of the Building Height and Tax Zone for the building, multiply the
8 applicable Base Services Special Tax from Table 4 by the Square Footage expected within
9 the building.

10
11 ▪ If the building for which a Certificate of Occupancy was issued is a Non-Residential
12 Building, based on the Tax Zone within which the Taxable Parcel is located, multiply the
13 applicable Base Services Special Tax from Table 4 by the Square Footage within the building.

14
15 ▪ If the building for which a Certificate of Occupancy was issued is Historic Building 2,
16 multiply the applicable Base Services Special Tax from Table 4 by the Square Footage within
17 Historic Building 2.

18
19 The Maximum Services Special Tax for Leasehold Interests in the Taxable Parcel shall be the
20 sum of the amount calculated pursuant to this Step 2 for each building on the Taxable Parcel
21 for which a Certificate of Occupancy has been issued.

22
23 If additional structures are anticipated to be built on the Taxable Parcel as shown in the
24 Development Approval Documents, the Administrator shall, regardless of the definitions set
25 forth herein, categorize each building for which a Certificate of Occupancy has been issued as

1 Developed Property, and any remaining buildings for which Certificates of Occupancy have
2 not yet been issued shall not be subject to a Services Special Tax until a Certificate of
3 Occupancy is issued for such remaining buildings. To determine the Services Special Tax for
4 any such Taxable Parcel, the Administrator shall take the sum of the Services Special Taxes
5 determined for each building.

6
7 **D. CHANGES TO THE MAXIMUM SPECIAL TAXES**

8
9 **1. *Annual Escalation of Facilities Special Tax, Shoreline Special Tax, and Arts***
10 ***Building Special Tax***

11
12 Beginning July 1, 2020 and each July 1 thereafter, each of the following amounts shall be
13 increased by 2% of the amount in effect in the prior Fiscal Year: the Base Facilities Special
14 Tax for each Tax Zone in Table 1; the Base Shoreline Special Tax for each Tax Zone in Table
15 2; the Base Arts Building Special Tax for each Tax Zone in Table 3; the Expected Maximum
16 Facilities Special Tax Revenues, the Expected Maximum Shoreline Special Tax Revenues,
17 and the Expected Maximum Arts Building Special Tax Revenues in Attachment 3; and the
18 Maximum Facilities Special Tax, the Maximum Shoreline Special Tax, and the Maximum Arts
19 Building Special Tax assigned to the Leasehold Interests in each Taxable Parcel.

20
21 **2. *Annual Escalation of Services Special Tax***

22
23 Beginning July 1, 2020 and each July 1 thereafter, the Base Services Special Tax for each
24 Tax Zone in Table 4 and the Maximum Services Special Tax assigned to the Leasehold
25 Interests in each Taxable Parcel shall be adjusted by the Escalator.

1
2 **3. *Changes in Square Footage Category on a Parcel of Developed Property***
3

4 If any Parcel that had been taxed as Developed Property in a prior Fiscal Year is rezoned or
5 otherwise has a Land Use Change, the Administrator shall, separately for each of the Special
6 Taxes, multiply the applicable Base Special Tax by the Square Footage within each new
7 Square Footage Category; if the First Bond Sale has not yet occurred, this amount shall be
8 the Maximum Special Tax for Leasehold Interests in the Parcel. If the First Bond Sale has
9 taken place, the Administrator shall apply the remainder of this Section D.3.
10

11 If the Maximum Special Tax that would apply to Leasehold Interests in the Parcel after the
12 Land Use Change is greater than the Maximum Special Tax that applied to Leasehold
13 Interests in the Parcel prior to the Land Use Change, the Administrator shall increase the
14 Maximum Special Tax for the Parcel to the amount calculated for each new Square Footage
15 Category. If the Maximum Special Tax after the Land Use Change is less than the Maximum
16 Special Tax that applied prior to the Land Use Change, there will be no change to the
17 Maximum Special Tax for Leasehold Interests in the Parcel. Under no circumstances shall
18 the Maximum Special Tax on Leasehold Interests in any Parcel of Developed Property be
19 reduced, regardless of changes in Square Footage Category or Square Footage on the
20 Parcel, including reductions in Square Footage that may occur due to demolition, fire, water
21 damage, or acts of God.
22
23
24
25

1 **4. *Changes to Planning Parcels and Expected Land Uses***

2
3 If, at any time prior to the First Bond Sale, the Developer or a Vertical Developer makes
4 changes to the boundaries of the Planning Parcels or the Expected Land Uses within one or
5 more Planning Parcels, the Administrator shall update the Expected Land Uses and Expected
6 Maximum Facilities Special Tax Revenues, Expected Maximum Shoreline Special Tax
7 Revenues, and Expected Maximum Arts Building Special Tax Revenues, which will be
8 reflected on an updated Attachment 3. In addition, the Administrator will request updated
9 Attachments 1 and 2 from the Developer.

10
11 If, after the First Bond Sale, the Developer or a Vertical Developer proposes to make changes
12 to the boundaries of the Planning Parcels or the Expected Land Uses within one or more
13 Planning Parcels, the Administrator shall meet with the Port, Developer, and any affected
14 Vertical Developers to review the proposed changes and evaluate the impact on the Expected
15 Maximum Facilities Special Tax Revenues, Expected Maximum Shoreline Special Tax
16 Revenues, and Expected Maximum Arts Building Special Tax Revenues. If the Administrator
17 determines that such changes will not reduce Required Coverage on Bonds that have been or
18 will be issued, the Port will decide whether to allow the proposed changes and corresponding
19 redistribution of the Expected Maximum Facilities Special Tax Revenues, Expected Maximum
20 Shoreline Special Tax Revenues, and Expected Maximum Arts Building Special Tax
21 Revenues. If such changes are permitted, the Administrator will update Attachment 3 and
22 request updated Attachments 1 and 2 from the Developer. If the Administrator determines that
23 the proposed changes will reduce Required Coverage on Bonds that have been issued, the
24 Port will not permit the changes.

1 **5. *Reduction in Maximum Facilities Special Taxes and Shoreline Special Taxes***
2 ***Prior to First Bond Sale***

3
4 Prior to the First Bond Sale, if the City, Port and Developer determine that assumptions that
5 were factored into estimates of Tax Increment at STD Formation have changed, and the
6 estimated Tax Increment is expected to be lower than the original estimates, the Port and
7 Developer may agree to a proportional or disproportional reduction in the Base Facilities
8 Special Tax or Base Shoreline Special Tax as set forth in Section 4.5(d) of the Financing
9 Plan. If the parties agree to such a reduction, the Port will direct the Administrator to use the
10 reduced Base Facilities Special Tax or Base Shoreline Special Tax for purposes of levying the
11 taxes pursuant to this RMA, and an amended Notice of Special Tax Lien reflecting the
12 reduction will be recorded against all Taxable Parcels within the STD. The reduction shall be
13 made without a vote of the qualified STD electors.

14
15 **6. *Affordable Leasehold Interests***

16
17 If an Affordable Unit Leasehold Interest is established within a Rental Residential Building, the
18 Expected Maximum Facilities Special Tax Revenues, Expected Maximum Shoreline Special
19 Tax Revenues, and Expected Maximum Arts Building Special Tax Revenues that were
20 assigned to the Rental Residential Building prior to such Affordable Unit Leasehold Interest
21 being established shall continue to apply regardless of the actual square footage included
22 within the Market-Rate Unit Leasehold Interest. The Expected Maximum Facilities Special
23 Tax Revenues, Expected Maximum Shoreline Special Tax Revenues, and Expected
24 Maximum Arts Building Special Tax Revenues assigned to the Market-Rate Unit Leasehold
25 Interest will be escalated pursuant to Section D.1 above.

1 **E. ANNEXATIONS**

2 If, in any Fiscal Year, a property owner within the Future Annexation Area wants to annex
3 property into the STD, the Administrator shall apply the following steps as part of the
4 annexation proceedings:

5
6 *Step 1.* Working with Port staff, the Administrator shall determine the Expected Land
7 Uses for the area to be annexed and the Tax Zone into which the property will
8 be placed.

9
10 *Step 2.* The Administrator shall prepare or have prepared updated Attachments 1, 2,
11 and 3 to reflect the annexed property and identify the revised Expected Land
12 Uses, Expected Maximum Facilities Special Tax Revenues, Expected Maximum
13 Shoreline Special Tax Revenues, and Expected Maximum Arts Building Special
14 Tax Revenues. After the annexation is complete, the application of this RMA
15 shall be based on the adjusted Expected Land Uses and Maximum Facilities
16 Special Tax Revenues, Maximum Shoreline Special Tax Revenues, and
17 Maximum Arts Building Special Tax Revenues, as applicable, including the
18 newly annexed property.

19
20 *Step 3.* The Administrator shall ensure that a Notice of Special Tax Lien is recorded
21 against all Parcels that are annexed to the STD.

22
23
24 **F. METHOD OF LEVY OF THE SPECIAL TAXES**

1. ***Facilities Special Tax***

Each Fiscal Year, the Administrator shall determine the Facilities Special Tax Requirement for the Fiscal Year, and the Facilities Special Tax shall be levied according to the steps outlined below:

Step 1. The Administrator shall determine the Facilities Special Tax to be levied on Leasehold Interests in each Taxable Parcel of Developed Property, as follows:

Step 1a. Calculate the Maximum Facilities Special Tax for each Leasehold Interest in each Parcel of Developed Property.

Step 1b. In consultation with the City, determine which Parcels of Developed Property are Assessed Parcels.

Step 1c. For all Parcels of Developed Property that are not Assessed Parcels, levy the Maximum Facilities Special Tax on Leasehold Interests in such Parcels. Any Remainder Special Taxes collected shall be applied pursuant to the Financing Plan.

Step 1d. For all Assessed Parcels:

Step 1dA. Determine the amount of the Parcel Increment.

1 **Step 1dB.** If the total amount of Parcel Increment available is equal to or greater than the
2 total aggregate Maximum Facilities Special Taxes for all Assessed Parcels, then the levy on
3 each Assessed Parcel shall be zero (\$0).

4
5 **Step 1dC.** If the total amount of Parcel Increment available is less than the aggregate
6 Maximum Facilities Special Taxes for all Assessed Parcels, the Administrator shall apply the
7 appropriate sub-step below:

8
9 **Substep 1dC(i).** *If, after coordination with the City and Port, the Administrator is*
10 *provided with a breakdown of Parcel Increment on a Parcel-by-Parcel basis in time for*
11 *submission of the Special Tax levy,* the Administrator shall determine the net tax levy on
12 Leasehold Interests in each Assessed Parcel (the "Net Assessed Parcel Tax Levy") by taking
13 the following steps in the following order of priority: (i) subtract from the Maximum Facilities
14 Special Tax for each Assessed Parcel the amount of Parcel Increment generated from the
15 applicable Assessed Parcel, and (ii) for each Assessed Parcel whose tax levy was not
16 reduced to \$0 pursuant to item (i) in this paragraph, apply any remaining Parcel Increment
17 that was not applied pursuant to item (i) in this paragraph to each such Assessed Parcel on a
18 pro rata basis (based on the Parcel's net remaining tax levy as a percentage of the aggregate
19 net remaining tax levy for all Parcels for which Parcel Increment was insufficient to pay the
20 Parcel's Maximum Facilities Special Tax). The Administrator shall levy on Leasehold
21 Interests in each Assessed Parcel the Net Assessed Parcel Tax Levy for such Assessed
22 Parcel. Any Remainder Special Taxes collected shall be applied pursuant to the Financing
23 Plan. In making the calculation pursuant to item (i) above for a Market-Rate Unit Leasehold
24 Interest in a building in the STD, the Parcel Increment to be subtracted from the Maximum
25 Facilities Special Tax assigned to the Market-Rate Unit Leasehold Interest shall be the

1 combined Parcel Increment generated from the Market-Rate Unit Leasehold Interest and the
2 Affordable Unit Leasehold Interest in the building.

3
4 **Substep 1dC(ii). *If, after coordination with the City and Port, the Administrator***
5 ***determines that a breakdown of Parcel Increment on a Parcel-by-Parcel basis cannot***
6 ***be provided in time for submission of the Special Tax levy,*** the Administrator shall
7 determine the net tax levy on the Leasehold Interest in each Assessed Parcel (the “Net
8 Assessed Parcel Tax Levy”) by subtracting from the Maximum Facilities Special Tax for each
9 Assessed Parcel a pro rata share of the Parcel Increment, with such pro rata share
10 determined based on each Parcel’s Maximum Facilities Special Tax as a percentage of the
11 aggregate Maximum Facilities Special Tax for all Parcels in the STD. The Administrator shall
12 levy on the Leasehold Interest in each Assessed Parcel the Net Assessed Parcel Tax Levy for
13 such Assessed Parcel. Any Remainder Special Taxes collected shall be applied pursuant to
14 the Financing Plan. In making the calculation pursuant to item (i) in Substep 1dC(i) above for
15 a Market-Rate Unit Leasehold Interest in a building in the STD, the Parcel Increment to be
16 subtracted from the Maximum Facilities Special Tax assigned to the Market-Rate Unit
17 Leasehold Interest shall be the combined Parcel Increment generated from the Market-Rate
18 Unit Leasehold Interest and the Affordable Unit Leasehold Interest in the building.

19 The Review Authority shall make the final determination regarding available Parcel Increment,
20 the Maximum Facilities Special Tax that applies to a Parcel based on the Leasehold Interests
21 in the Parcel, and the application of Parcel Increment pursuant to Substeps 1dC(i). and 1dC(ii)
22 above.

23
24 **Step 2.** After the First Bond Sale, if additional revenue is needed after Step 1 in order to
25 meet the Facilities Special Tax Requirement after Capitalized Interest has been applied to

1 reduce the Facilities Special Tax Requirement, the Facilities Special Tax shall be levied
2 Proportionately on Leasehold Interests in each Taxable Parcel of Undeveloped Property, in an
3 amount up to 100% of the Maximum Facilities Special Tax for Leasehold Interests in each
4 Taxable Parcel of Undeveloped Property for such Fiscal Year.

5
6 **2. Shoreline Special Tax**

7
8 Each Fiscal Year, the Maximum Shoreline Special Tax shall be levied on Leasehold Interests
9 in each Taxable Parcel of Developed Property. Any Remainder Special Taxes collected shall
10 be applied as set forth in the Financing Plan. The Shoreline Special Tax may not be levied on
11 Undeveloped Property.

12
13 **3. Arts Building Special Tax**

14
15 Each Fiscal Year, the Maximum Arts Building Special Tax shall be levied on Leasehold
16 Interests in each Taxable Parcel of Developed Property. Any Remainder Special Taxes
17 collected shall be applied as set forth in the Financing Plan. The Arts Building Special Tax
18 may not be levied on Undeveloped Property.

19
20 **4. Services Special Tax**

21
22 Each Fiscal Year, the Administrator shall coordinate with the City and the Port to determine
23 the Services Special Tax Requirement for the Fiscal Year. The Services Special Tax shall
24 then be levied Proportionately on Leasehold Interests in each Taxable Parcel of Developed
25 Property, in an amount up to 100% of the Maximum Services Special Tax for Leasehold

1 Interests in each Parcel of Developed Property for such Fiscal Year until the amount levied is
2 equal to the Services Special Tax Requirement. The Services Special Tax may not be levied
3 on Undeveloped Property.

4
5 **G. COLLECTION OF SPECIAL TAXES**

6
7 Special Taxes shall be collected in the same manner and at the same time as ordinary ad
8 valorem property taxes on the regular tax roll, provided, however, that the City may directly bill
9 Special Taxes, may collect Special Taxes at a different time or in a different manner, and may
10 collect delinquent Special Taxes through foreclosure or other available methods as authorized
11 by the CFD Law. The Board has ordered any Special Taxes to be levied on Leasehold
12 Interests to be levied on the secured roll. The Special Tax bill for any Taxable Parcel subject
13 to a Leasehold Interest will be sent to the same party that receives the possessory interest tax
14 bill associated with the Leasehold Interest unless it is sent directly to the Taxpayer.

15
16 In calculating the Facilities Special Tax Requirement, under no circumstances may the
17 Facilities Special Tax that is levied on a Leasehold Interest in a Taxable Parcel in a Fiscal
18 Year be increased by more than ten percent (10%) of the Maximum Facilities Special Tax for
19 that Parcel (or such lesser amount required by the CFD Law) as a consequence of
20 delinquency or default in payment of Facilities Special Taxes levied on Leasehold Interests in
21 another Parcel(s) in the STD (the "Delinquency Levy").

22
23 The Delinquency Levy, if any, is determined when calculating the Facilities Special Tax
24 Requirement. Accordingly, when determining the levy of Facilities Special Taxes on
25 Leasehold Interests in Assessed Parcels pursuant to Step 1 of Section F.1, the Delinquency

1 Levy, if any, has already been applied and, therefore, the Administrator shall not levy any
2 additional Delinquency Levy on an Assessed Parcel that has its Facilities Special Tax levy
3 reduced or eliminated by Parcel Increment.

4
5 The Facilities Special Tax shall be levied and collected on Leasehold Interests in each
6 Taxable Parcel until the earlier of: (i) the Fiscal Year in which the Port determines that all
7 Authorized Expenditures that will be funded by the STD have been funded and all Facilities
8 Special Tax Bonds have been fully repaid; (ii) the Fiscal Year after the Fiscal Year in which
9 Tax Increment is no longer collected within the Sub-Project Area within which the Taxable
10 Parcel is located and all Facilities Special Tax Bonds have been fully repaid, as determined by
11 the Administrator with direction from the Deputy Director; and (iii) Fiscal Year 2093-94.

12
13 The Shoreline Special Tax shall be levied on and collected from Leasehold Interests in each
14 Taxable Parcel for 120 Fiscal Years.

15
16 The Arts Building Special Tax shall be levied and collected until the earlier of: (i) the Fiscal
17 Year in which the Port determines that all Arts Building Costs have been funded and all Arts
18 Building Special Tax Bonds have been fully repaid; and (ii) Fiscal Year 2080-81.

19
20 The Services Special Tax shall be levied and collected in perpetuity.

1 **H. EXEMPTIONS**

2
3 Notwithstanding any other provision of this RMA, no Special Taxes will be levied on fee
4 simple interests in the STD, including Tax-Exempt Port Parcels. In addition, no Special Taxes
5 shall be levied on Affordable Unit Leasehold Interests.
6

7
8 **I. INTERPRETATION OF SPECIAL TAX FORMULA**

9 The City may interpret, clarify, and revise this RMA to correct any inconsistency, vagueness,
10 or ambiguity, by resolution or ordinance, as long as such interpretation, clarification, or
11 revision does not materially affect the levy and collection of the Special Taxes and any
12 security for any Bonds.
13

14 **J. SPECIAL TAX APPEALS**

15
16 Any Taxpayer who wishes to challenge the accuracy of computation of the Special Taxes in
17 any Fiscal Year may file an application with the Administrator. The Administrator, in
18 consultation with the City Attorney, shall promptly review the Taxpayer's application. If the
19 Administrator concludes that the computation of the Special Taxes was not correct, the
20 Administrator shall correct the Special Tax levy and, if applicable in any case, a refund shall
21 be granted. If the Administrator concludes that the computation of the Special Taxes was
22 correct, then such determination shall be final and conclusive, and the Taxpayer shall have no
23 appeal to the Board from the decision of the Administrator.
24
25

1 The filing of an application or an appeal shall not relieve the Taxpayer of the obligation to pay
2 the Special Taxes when due.

3 Nothing in this Section J shall be interpreted to allow a Taxpayer to bring a claim that would
4 otherwise be barred by applicable statutes of limitation set forth in the CFD Law or elsewhere
5 in applicable law.
6
7
8
9
10
11
12
13
14
15
16
17
18
19
20
21
22
23
24
25

ATTACHMENT 1

CITY AND COUNTY OF SAN FRANCISCO SPECIAL TAX DISTRICT No. 2019-2 (PIER 70 LEASED PROPERTIES)

IDENTIFICATION OF PLANNING PARCELS

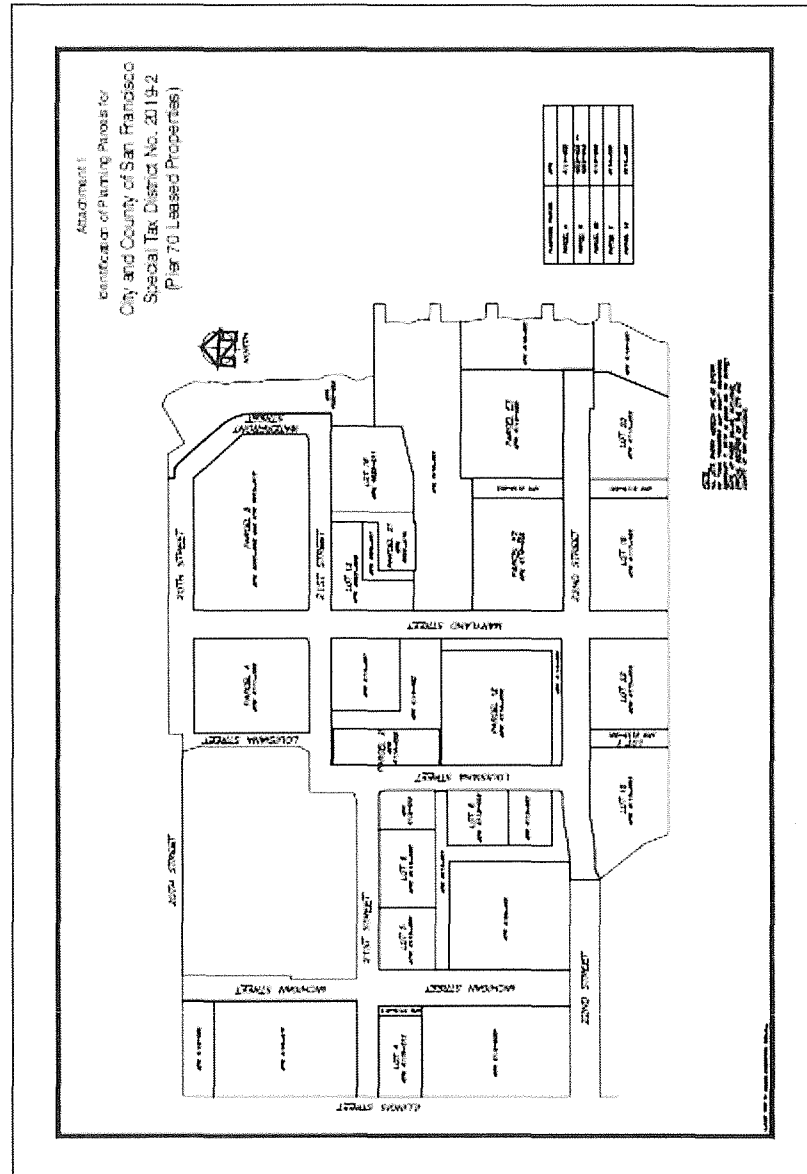

ATTACHMENT 2

CITY AND COUNTY OF SAN FRANCISCO SPECIAL TAX DISTRICT No. 2019-2 (PIER 70 LEASED PROPERTIES)

IDENTIFICATION OF TAX ZONES

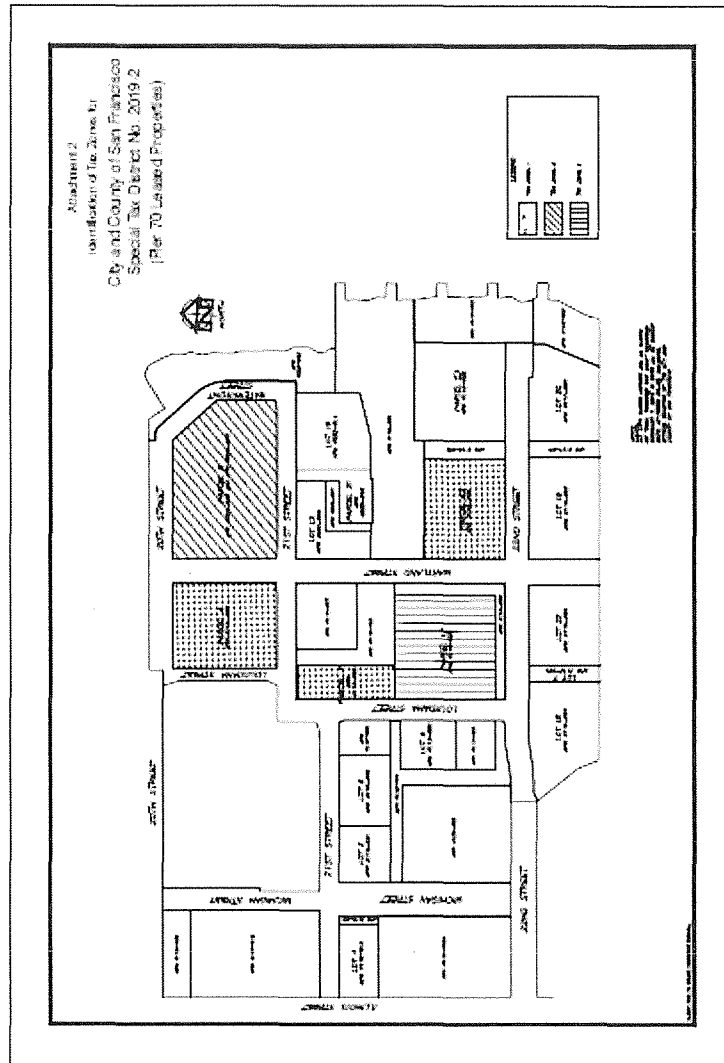

ATTACHMENT 3

CITY AND COUNTY OF SAN FRANCISCO
SPECIAL TAX DISTRICT NO. 2019-2
(PIER 70 LEASED PROPERTIES)

EXPECTED LAND USES, EXPECTED MAXIMUM FACILITIES SPECIAL TAX REVENUES, EXPECTED
MAXIMUM SHORELINE SPECIAL TAX REVENUES, AND
EXPECTED MAXIMUM ARTS BUILDING SPECIAL TAX REVENUES

Planning Parcel	Expected Land Uses	Expected Square Footage	Expected Maximum Facilities Special Tax Revenues (FY 2019-20)*	Expected Maximum Shoreline Special Tax Revenues (FY 2019-20)*	Expected Maximum Arts Building Special Tax Revenues (FY 2019-20)*
TAX ZONE 1					
Parcel A	Non-Residential Building	265,743	\$993,879	\$151,473	\$140,844
Parcel 2	Historic Building 2	87,300	\$325,629	\$49,761	\$37,539
Parcel E2	Rental Residential Buildings with Building Heights less than or equal to 70 feet	254,931	\$950,893	\$145,311	\$109,620
TAX ZONE 2					
Parcel B	Non-Residential Building	450,709	\$1,685,652	\$387,610	\$238,876
TAX ZONE 3					
Parcel 12	Historic Building 12	141,300	\$497,376	\$0	\$0
TOTAL	N/A	1,199,983	\$4,453,429	\$734,155	\$526,879

*Beginning July 1, 2020 and each July 1 thereafter the Base Facilities Special Tax, the Base Shoreline Special Tax, and the Base Arts Building Special Tax shall be escalated as set forth in Section D.1.



City and County of San Francisco
Tails
Resolution

City Hall
1 Dr. Carlton B. Goodlett Place
San Francisco, CA 94102-4689

File Number: 191168

Date Passed: January 14, 2020

Resolution of formation of the City and County of San Francisco Special Tax District No. 2019-2 (Pier 70 Leased Properties) and a future annexation area; determining other matters in connection therewith, as defined herein; and making findings under the California Environmental Quality Act.

January 14, 2020 Board of Supervisors - ADOPTED

Ayes: 11 - Fewer, Haney, Mandelman, Mar, Peskin, Preston, Ronen, Safai, Stefani, Walton and Yee

File No. 191168

I hereby certify that the foregoing
Resolution was ADOPTED on 1/14/2020 by
the Board of Supervisors of the City and
County of San Francisco.

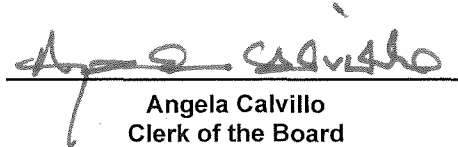
Angela Calvillo
Clerk of the Board

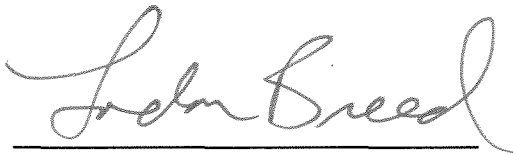
London N. Breed
Mayor

Date Approved